

KINGSLEY ROAD

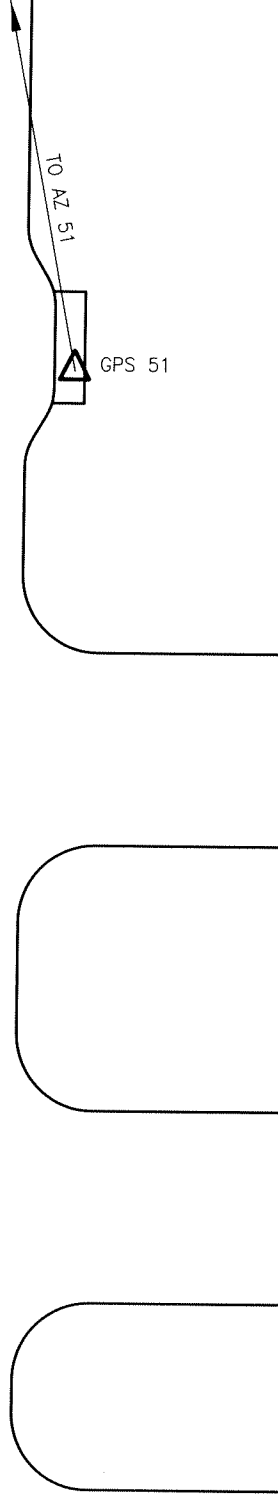

SATURN ROAD

Scale : N/A Date : 10/05

Design : COG

Drawn : COG

Dwg. File : GPS51.DWG

Dir. : G:/ENG/GPS-AZH

GARLAND
ENGINEERING DEPARTMENT
STANDARD DETAILS

Garland Monument
GPS 51

Dallas Mapsco 29-Q

SHEET

1

OF

1



51 AZ

MARYDALE ROAD

KINGSLEY ROAD

TO GPS 51

Scale : N/A Date : 10/05

Design : COG

Drawn : COG

Dwg. File : GPS51AZ.DWG

Dir. : G:/ENG/GPS-AZH

GARLAND
ENGINEERING DEPARTMENT
STANDARD DETAILS

Garland Monument
GPS AZIMUTH 51

SHEET

1

OF

1

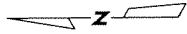

DAIRY ROAD

HIGHWAY 66

BRIDGE

GPS 52

TO AZ 52

Scale : N/A Date : 10/05

Design : COG

Drawn : COG

Dwg. File : GPS52.DWG

Dir. : G:/ENG/GPS-AZH

GARLAND
ENGINEERING DEPARTMENT
STANDARD DETAILS

Garland Monument
GPS 52

Dallas Mapsco 29A-B

SHEET

1

OF

1

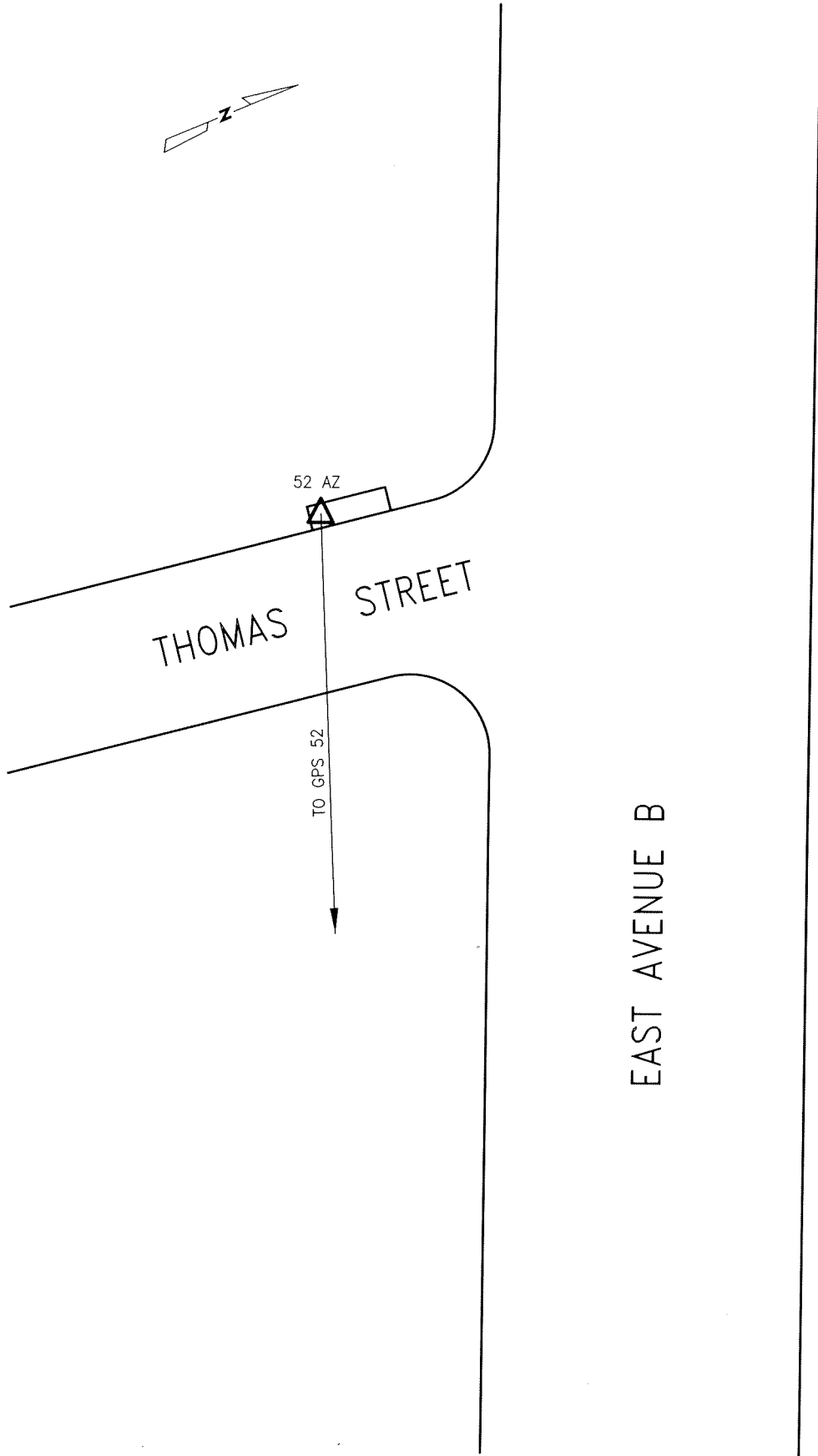

THOMAS STREET

EAST AVENUE B

52 AZ

TO GPS 52

Scale : N/A Date : 10/05
Design : COG
Drawn : COG
Dwg. File : GPS52AZ.DWG
Dir. : G:/ENG/GPS-AZH

GARLAND
ENGINEERING DEPARTMENT
STANDARD DETAILS

Garland Monument
GPS AZIMUTH 52

SHEET
1
OF
1

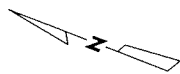

FIREWHEEL PARKWAY

CROSSLAND DRIVE

GPS 53

TO AZ 53

Scale : N/A Date : 10/05

Design : COG

Drawn : COG

Dwg. File : GPS53.DWG

Dir. : G:/ENG/GPS-AZH

GARLAND
ENGINEERING DEPARTMENT
STANDARD DETAILS

Garland Monument
GPS 53

Dallas Mapsco 19A-L

SHEET

1

OF

1

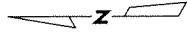

BREANNA WAY

TO GPS 53

53 AZ

CROSSLAND DRIVE

ESSEX DRIVE

Scale : N/A Date : 10/05

Design : COG

Drawn : COG

Dwg. File : GPS53AZ.DWG

Dir. : G:/ENG/GPS-AZH

GARLAND
ENGINEERING DEPARTMENT
STANDARD DETAILS

Garland Monument
GPS AZIMUTH 53

SHEET

1

OF

1

NORTH GARLAND AVENUE

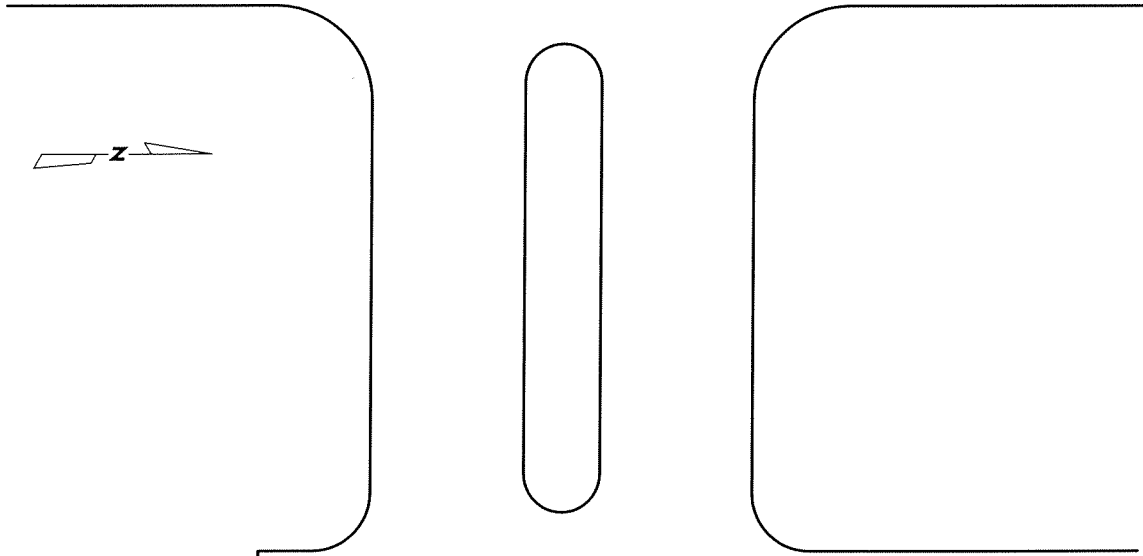

SUNNINGDALE DRIVE



GPS 55

WEST MUIRFIELD DRIVE

TO AZ 54

Scale : N/A Date : 10/05
 Design : COG
 Drawn : COG
 Dwg. File : GPS54.DWG
 Dir. : G:/ENG/GPS-AZH

GARLAND
 ENGINEERING DEPARTMENT
 STANDARD DETAILS

Garland Monument
GPS 54

Dallas Mapsco 9-V

SHEET
 1
 OF
 1

SCHOOL ENTRANCE

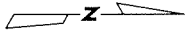

TO GPS 54

54 AZ

MUIRFIELD ROAD

TURNBERRY DRIVE

Scale : N/A Date : 10/05

Design : COG

Drawn : COG

Dwg. File : GPS54AZ.DWG

Dir. : G:/ENG/GPS-AZH

GARLAND
ENGINEERING DEPARTMENT
STANDARD DETAILS

Garland Monument
GPS AZIMUTH 54

SHEET

1

OF

1

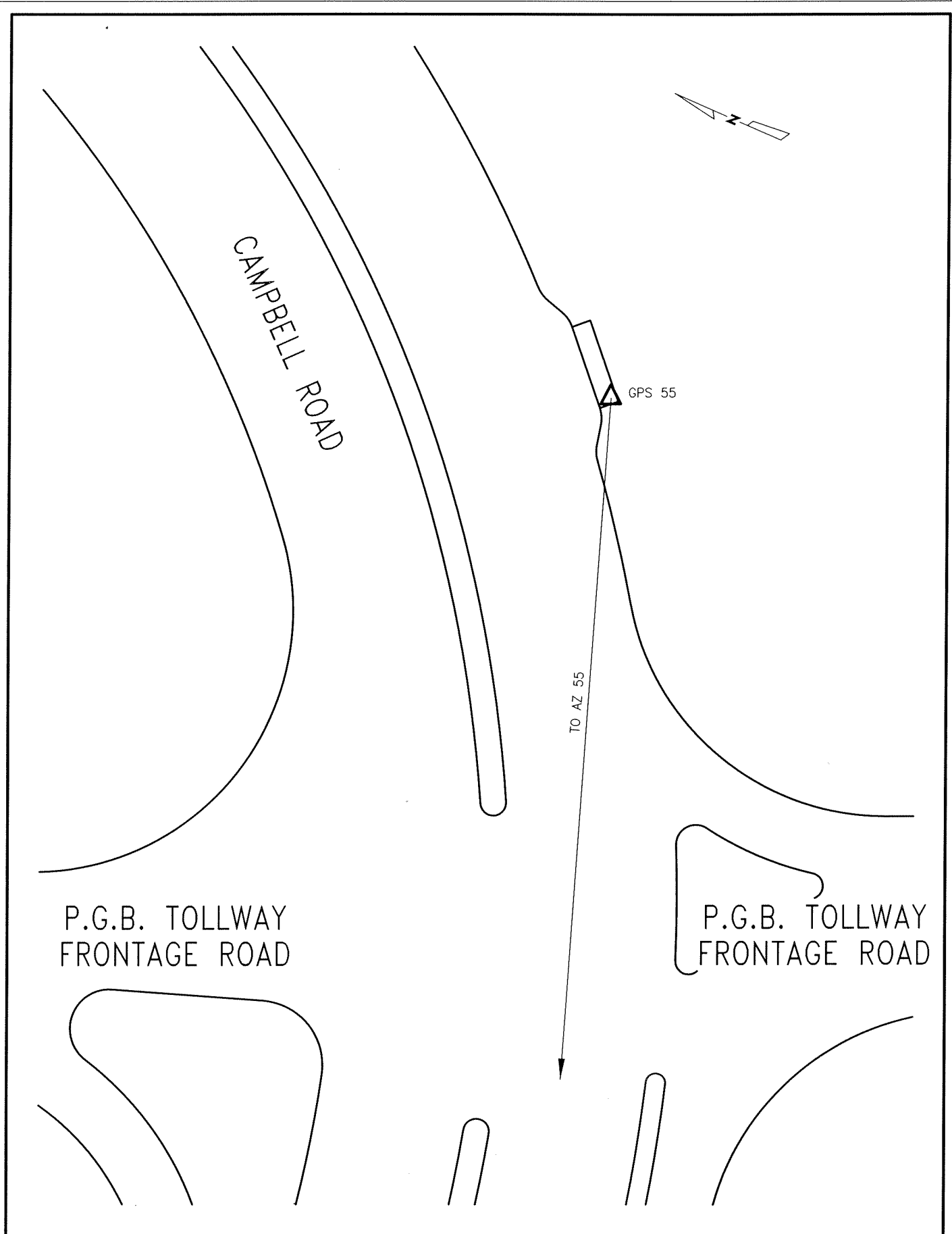

Scale : N/A Date : 10/05
 Design : COG
 Drawn : COG
 Dwg. File : GPS55.DWG
 Dir. : G:/ENG/GPS-AZH

GARLAND
 ENGINEERING DEPARTMENT
 STANDARD DETAILS

Garland Monument
GPS 55
 Dallas Mapsco 9-T

SHEET
 1
 OF
 1



ENTRANCE TO APTS.

55 AZ

TO GPS 55

CAMPBELL ROAD

S.B. P.G.B. TOLLWAY SERVICE RD.

Scale : N/A Date : 10/05

Design : COG

Drawn : COG

Dwg. File : GPS55AZ.DWG

Dir. : G:/ENG/GPS-AZH

GARLAND
ENGINEERING DEPARTMENT
STANDARD DETAILS

Garland Monument
GPS AZIMUTH 55

SHEET

1

OF

1

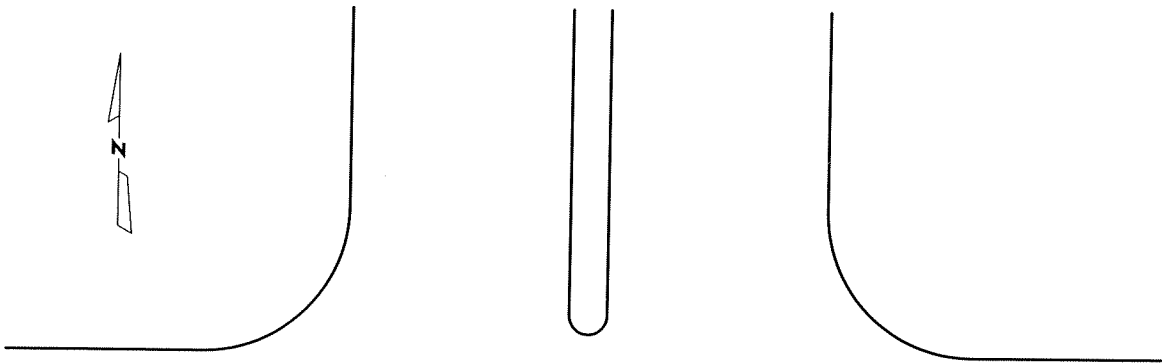

APOLLO ROAD

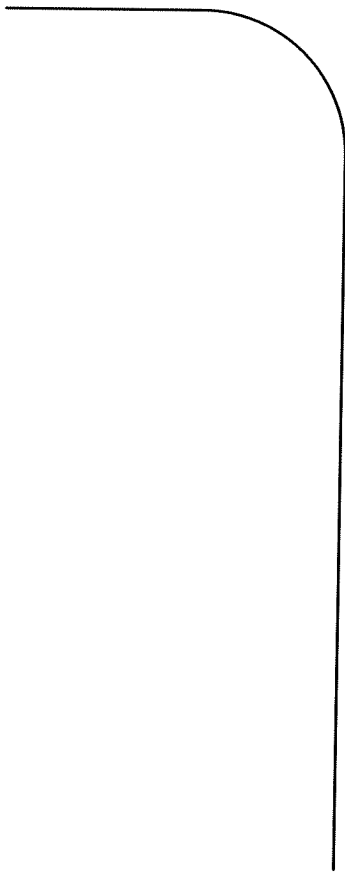
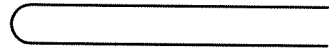
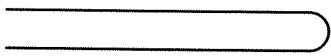

SHILOH ROAD

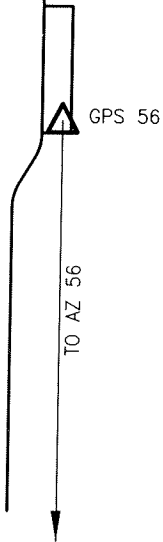

Scale : N/A Date : 10/05

Design : COG

Drawn : COG

Dwg. File : GPS56.DWG

Dir. : G:/ENG/GPS-AZH

GARLAND
ENGINEERING DEPARTMENT
STANDARD DETAILS

Garland Monument
GPS 56

Dallas Mapsco 19-A

SHEET

1

OF

1

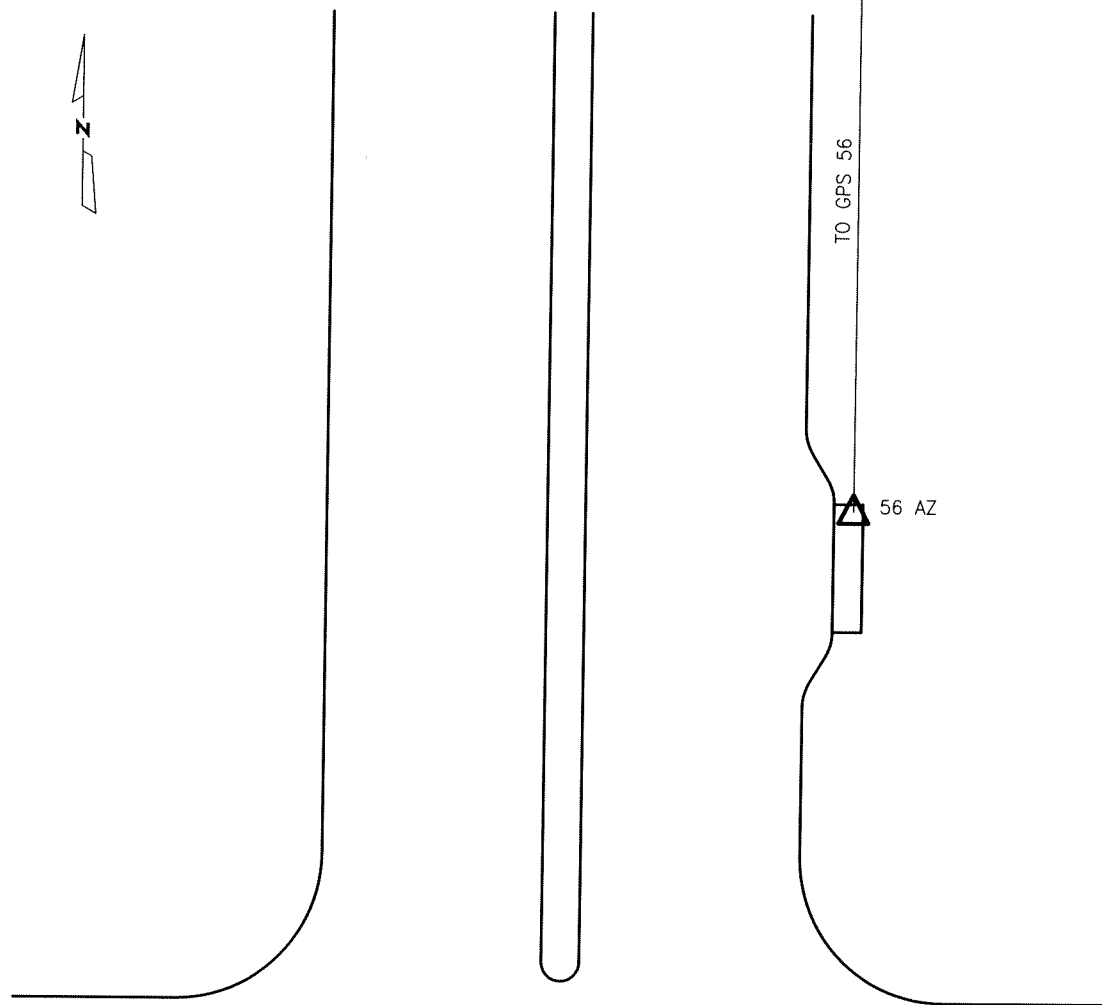
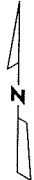

CENTAURUS

SHILOH ROAD

Scale : N/A Date : 10/05
Design : COG
Drawn : COG
Dwg. File : GPS56AZ.DWG
Dir. : G:/ENG/GPS-AZH

GARLAND
ENGINEERING DEPARTMENT
STANDARD DETAILS

Garland Monument
GPS AZIMUTH 56

SHEET
1
OF
1

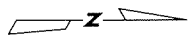

NORTH SHILOH ROAD

WEST BUCKINGHAM ROAD

GPS 57



TO AZ 57

Scale : N/A Date : 10/05
 Design : COG
 Drawn : COG
 Dwg. File : GPS57.DWG
 Dir. : G:/ENG/GPS-AZH



Garland Monument
GPS 57
 Dallas Mapsco 19-N

SHEET
 1
 OF
 1

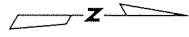

HOLLYWOOD
VIDEO

WEST BUCKINGHAM ROAD

TO GPS 57

57 AZ

CLEARVIEW DRIVE

SCHOOL ENTRANCE

Scale : N/A Date : 10/05

Design : COG

Drawn : COG

Dwg. File : GPS57AZ.DWG

Dir. : G:/ENG/GPS-AZH

GARLAND
ENGINEERING DEPARTMENT
STANDARD DETAILS

Garland Monument
GPS AZIMUTH 57

SHEET

1

OF

1

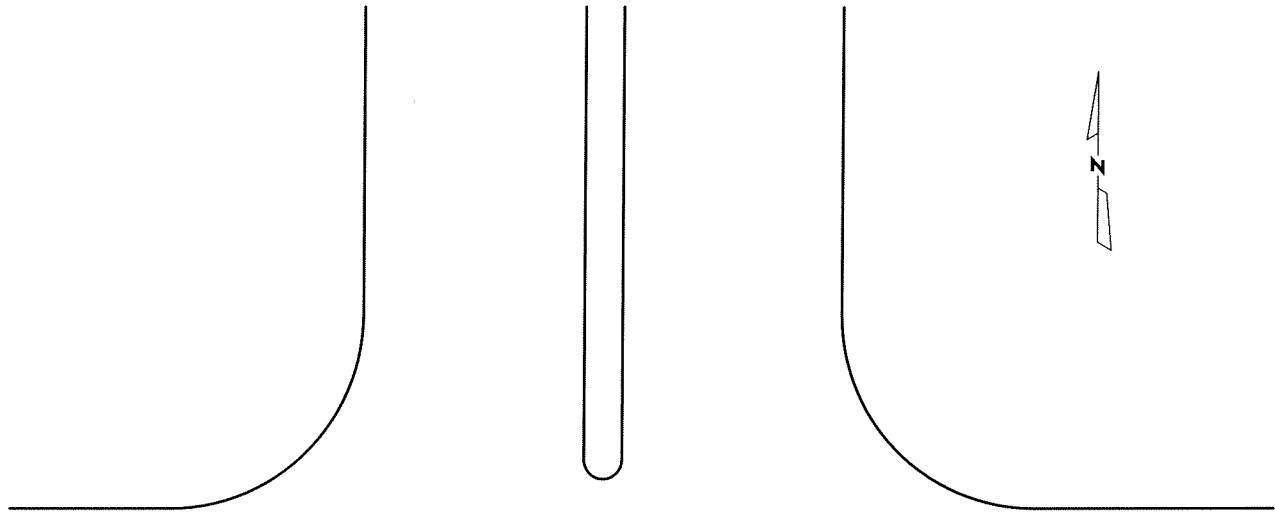

FOREST LANE

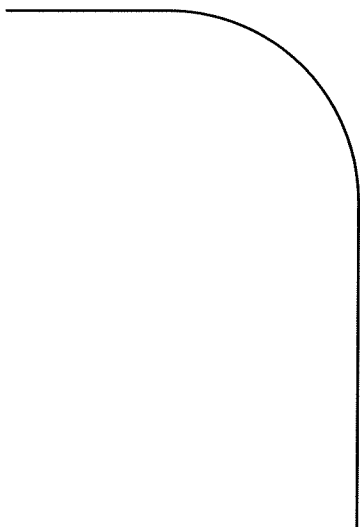
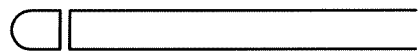
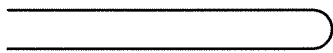

PLANO ROAD

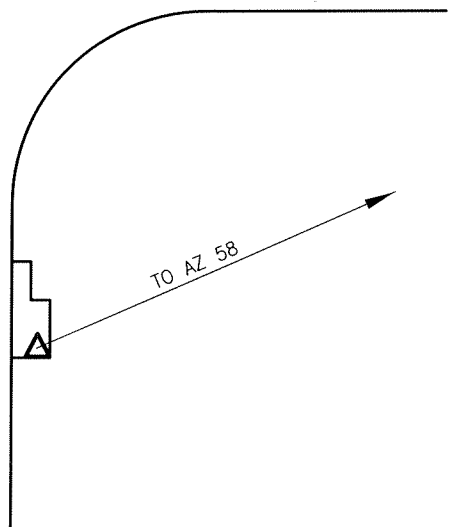

TO AZ 58

Scale : N/A Date : 10/05
 Design : COG
 Drawn : COG
 Dwg. File : GPS58.DWG
 Dir. : G:/ENG/GPS-AZH

GARLAND
 ENGINEERING DEPARTMENT
 STANDARD DETAILS

Garland Monument
GPS 58
 Dallas Mapsco 18-W

SHEET
 1
 OF
 1

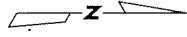

CHAIRMAN RD.

TO GPS 58

S AND C
AUTO PAINT
AND BODY

FOREST LANE

58 AZ

FENCE
SUPPLY

Scale : N/A Date : 10/05
 Design : COG
 Drawn : COG
 Dwg. File : GPS59.DWG
 Dir. : G:/ENG/GPS-AZH

GARLAND
 ENGINEERING DEPARTMENT
 STANDARD DETAILS

Garland Monument
GPS AZIMUTH 58

SHEET
 1
 OF
 1

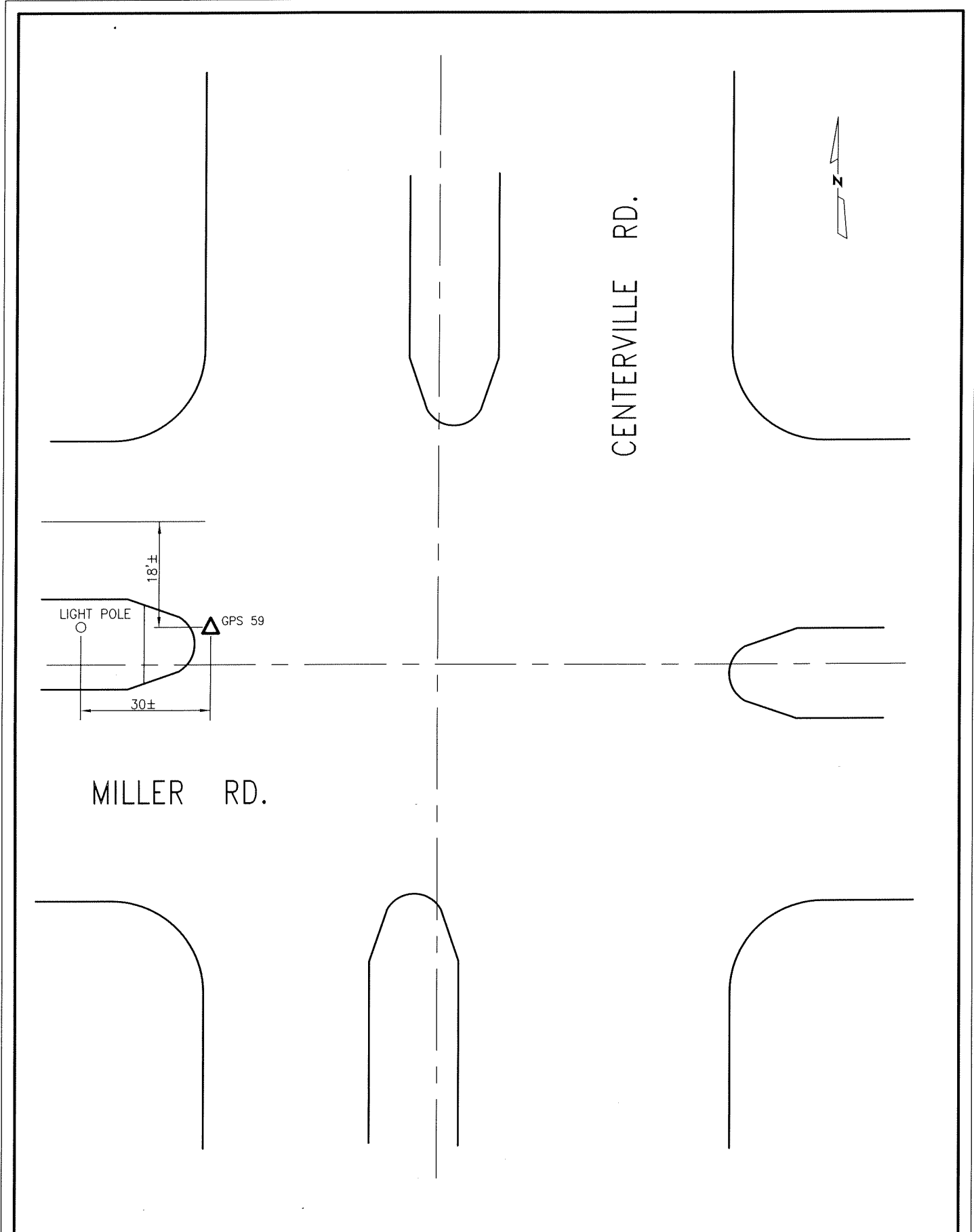

Scale : N/A Date : 10/05
 Design : COG
 Drawn : COG
 Dwg. File : GPS59.DWG
 Dir. : G:/ENG/GPS-AZH



Garland Monument
GPS 59
 Dallas Mapsco 29A-H

SHEET
 1
 OF
 1

THERE IS NO AZIMUTH
FOR GPS 59
AT THIS TIME

Scale : N/A Date : 10/05

Design : COG

Drawn : COG

Dwg. File : GPS59AZ.DWG

Dir. : G:/ENG/GPS-AZH

GARLAND
ENGINEERING DEPARTMENT
STANDARD DETAILS

Garland Monument
GPS AZIMUTH 59

Dallas Mapsco 29A-H

SHEET

1

OF

1

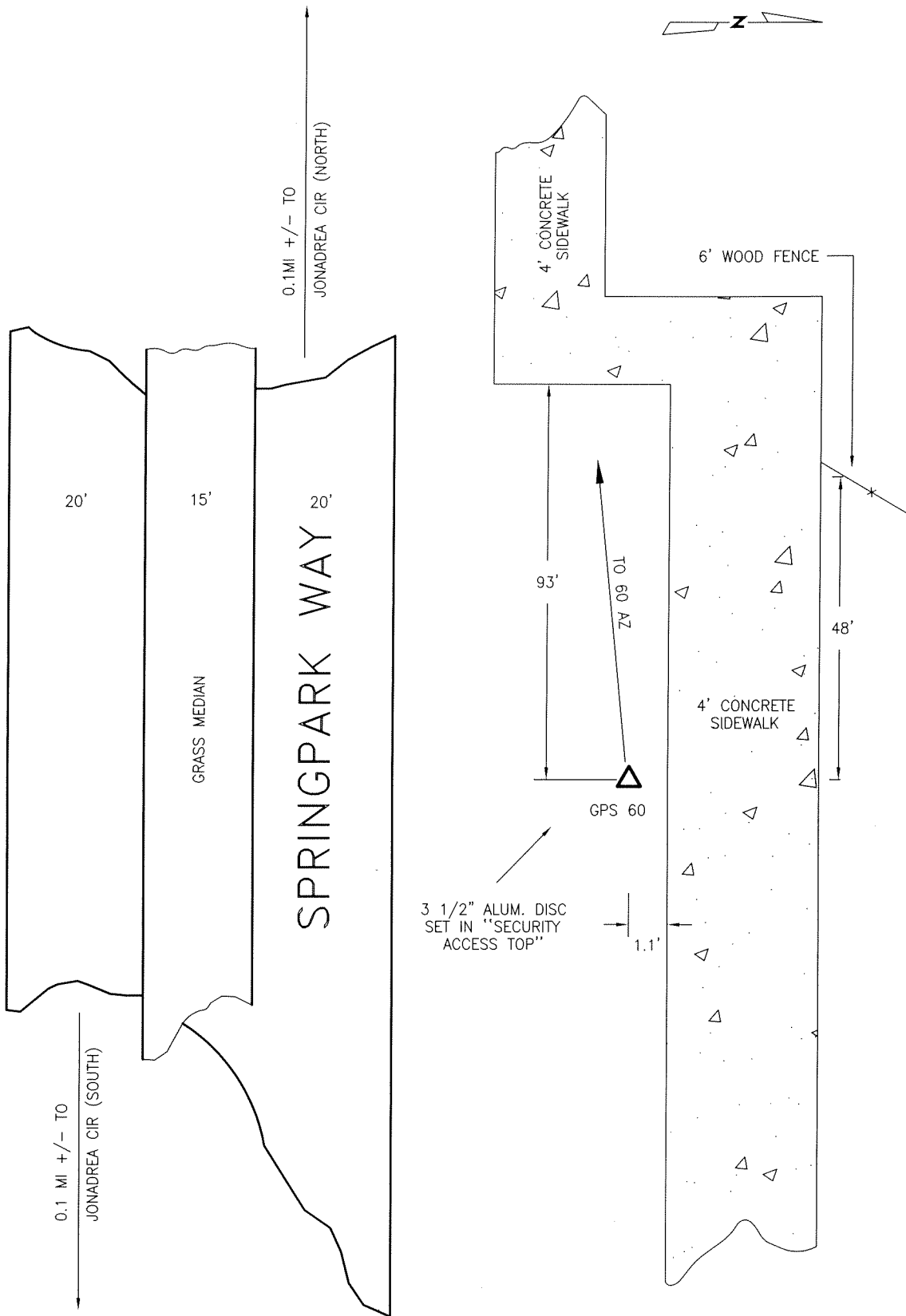

Scale : N/A Date : 10/05
 Design : COG
 Drawn : COG
 Dwg. File : GPS60.DWG
 Dir. : G:/ENG/GPS-AZH

GARLAND
 ENGINEERING DEPARTMENT
 STANDARD DETAILS

Garland Monument
GPS 60
 Dallas Mapsco 8-R

SHEET
 1
 OF
 1

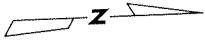

FH
97'

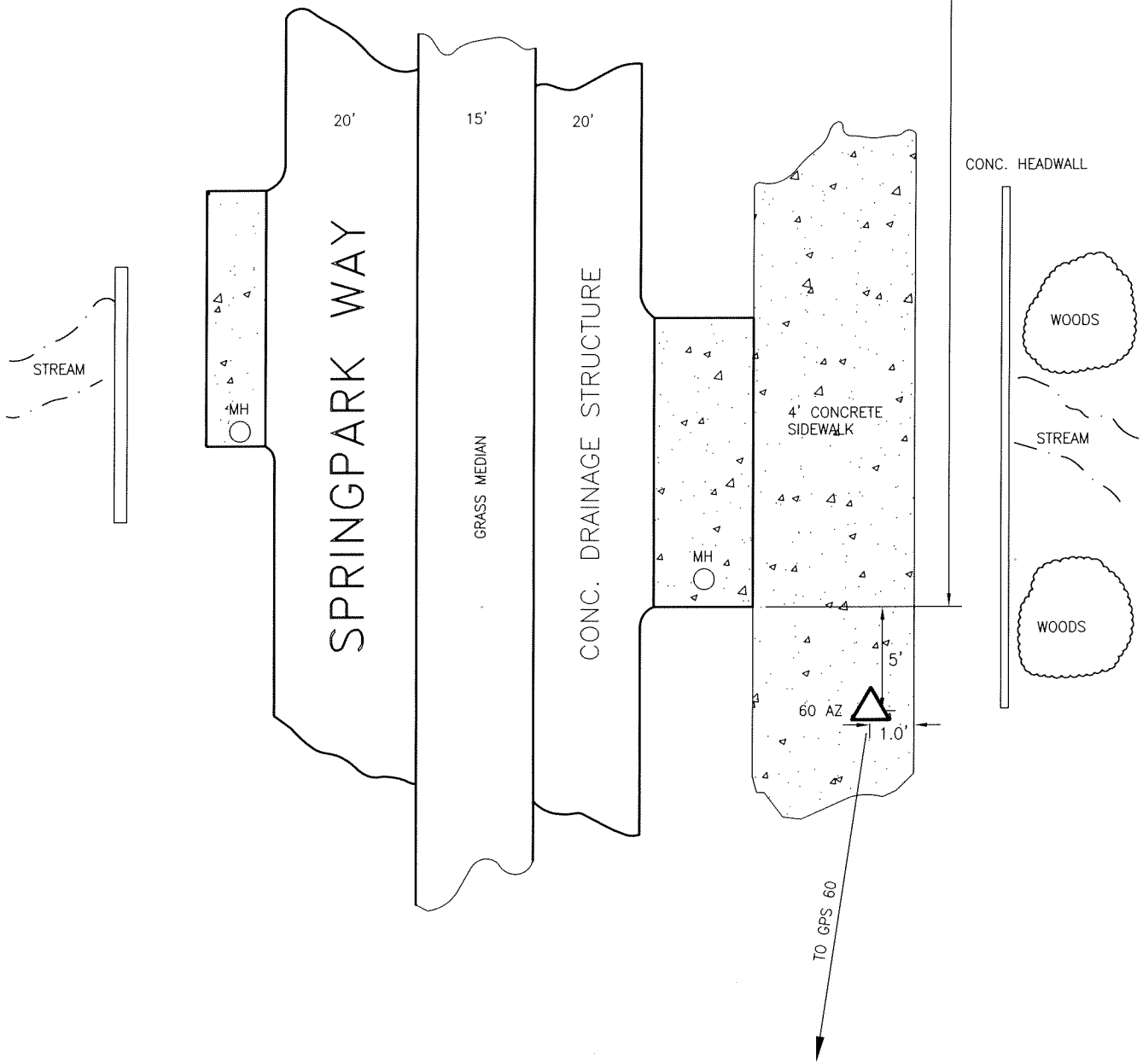

Scale : N/A Date : 10/05
 Design : COG
 Drawn : COG
 Dwg. File : GPS60AZ.DWG
 Dir. : G:/ENG/GPS-AZH

GARLAND
 ENGINEERING DEPARTMENT
 STANDARD DETAILS

Garland Monument
 GPS AZIMUTH 60

SHEET
 1
 OF
 1

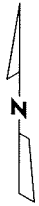

EXIT OFF
#78 TO 190 W

METAL
GUARD
RAIL

GRASS
MEDIAN

3RD POST

2ND POST

GPS 61
MON. & COVER

33'

TO GPS 61 AZ

P.G.B. TOLLWAY
(a.k.a. HWY 190 N.W.)

CONC.
MEDIAN

BRIDGE

P.G.B. TOLLWAY
(a.k.a. HWY 190 S.E.)
(DIVIDED HWY)

HWY 78
(LAVON)

Scale : N/A Date : 10/05

Design : COG

Drawn : COG

Dwg. File : GPS61.DWG

Dir. : G:/ENG/GPS-AZH

GARLAND
ENGINEERING DEPARTMENT
STANDARD DETAILS

Garland Monument
GPS 61

Dallas Mapsco 19-B

SHEET

1

OF

1



WEST BOUND HWY 190
CONC. PAV

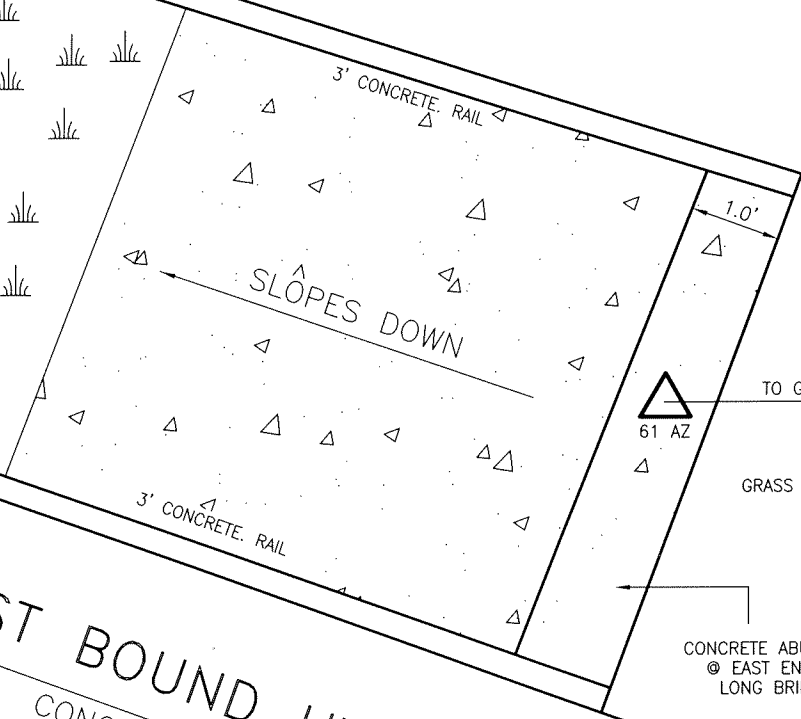
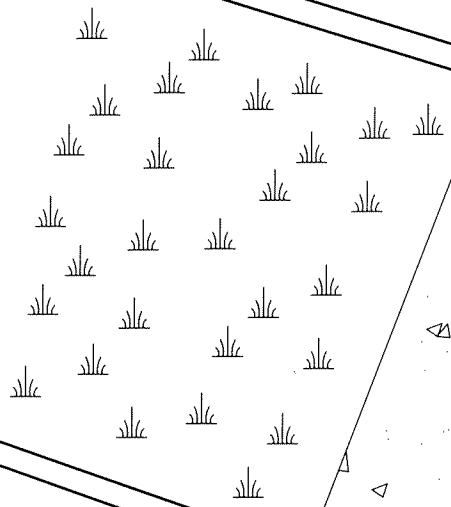

EAST BOUND HWY 190
CONC. PAV

TO HWY 78

Scale : N/A Date : 10/05
Design : COG
Drawn : COG
Dwg. File : GPS61AZ.DWG
Dir. : G:/ENG/GPS-AZH

GARLAND
ENGINEERING DEPARTMENT
STANDARD DETAILS

Garland Monument
GPS AZIMUTH 61

SHEET
1
OF
1

WOODLAND DR.



.GPS 62 WAS ESTABLISHED TO BE USED IN LIEU OF GPS 24,
WHICH WAS NOT SUITABLE DUE TO LIMITED SIGHT DISTANCES.
GPS 62 AZ IS THE AZIMUTH MARK FOR GPS 62.
(GPS 24 WAS FOUND IN GOOD CONDITION & NOT DISTURBED)

SYLVAN DR.

WOODLAND PARK
CITY OF GARLAND

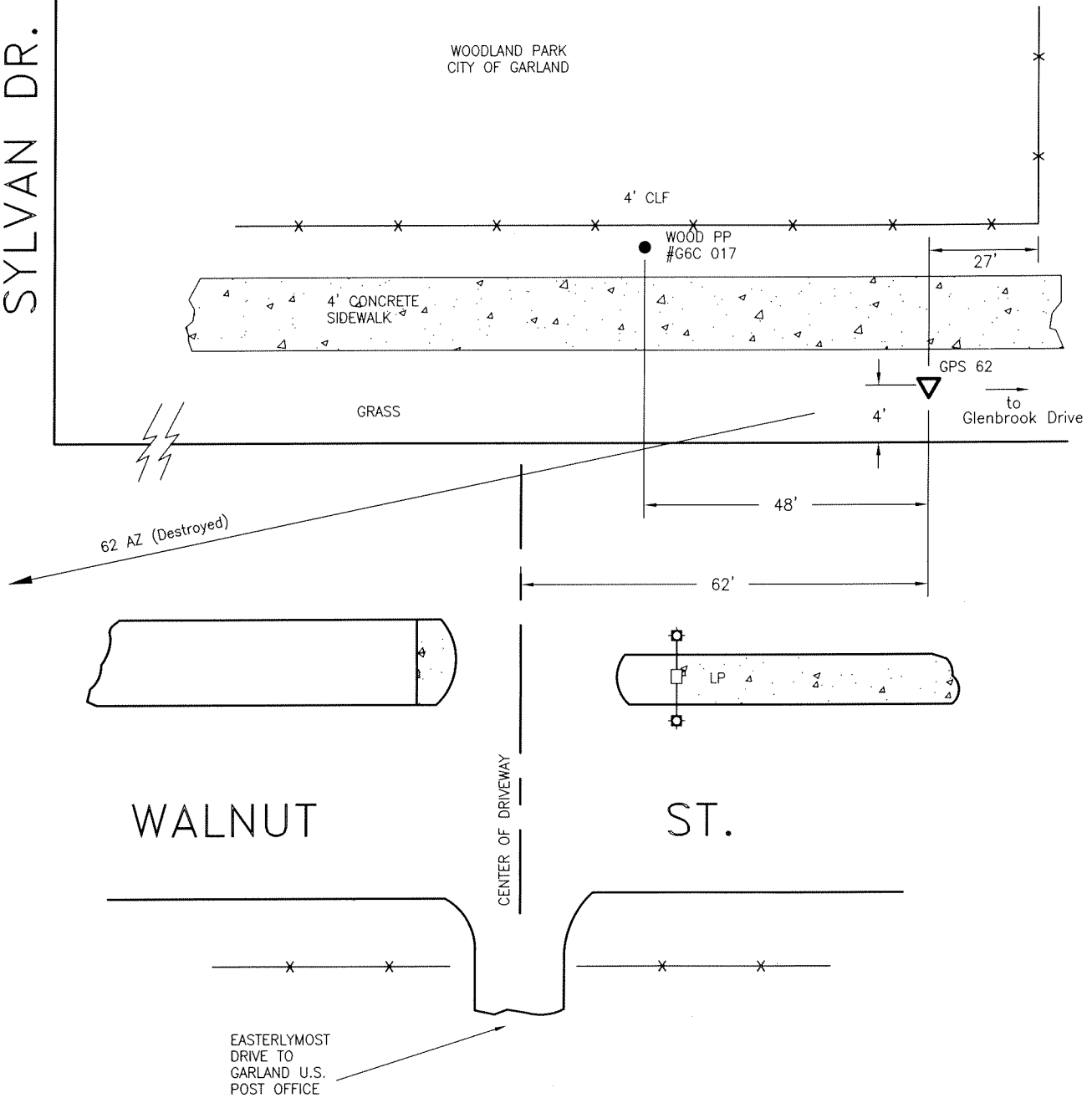

Scale : N/A	Date : 10/05
Design : COG	
Drawn : COG	
Dwg. File : GPS62.DWG	
Dir. : G:/ENG/GPS-AZH	

GARLAND
ENGINEERING DEPARTMENT
STANDARD DETAILS

Garland Monument
GPS 62
Dallas Mapsco29A-C

SHEET
1
OF
1



HILLCREST
24' CONCRETE
PAVEMENT

WEST WALNUT

STREET

CONCRETE DRAINAGE
STRUCTURE

62AZ

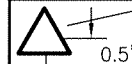

4' CONCRETE
SIDEWALK

NEWMAN

DESTROYED

TO GPS 62

Scale : N/A Date : 10/05

Design : COG

Drawn : COG

Dwg. File : GPS62AZ.DWG

Dir. : G;/ENG/GPS-AZH

GARLAND
ENGINEERING DEPARTMENT
STANDARD DETAILS

Garland Monument
GPS AZIMUTH 62

SHEET

1

OF

1

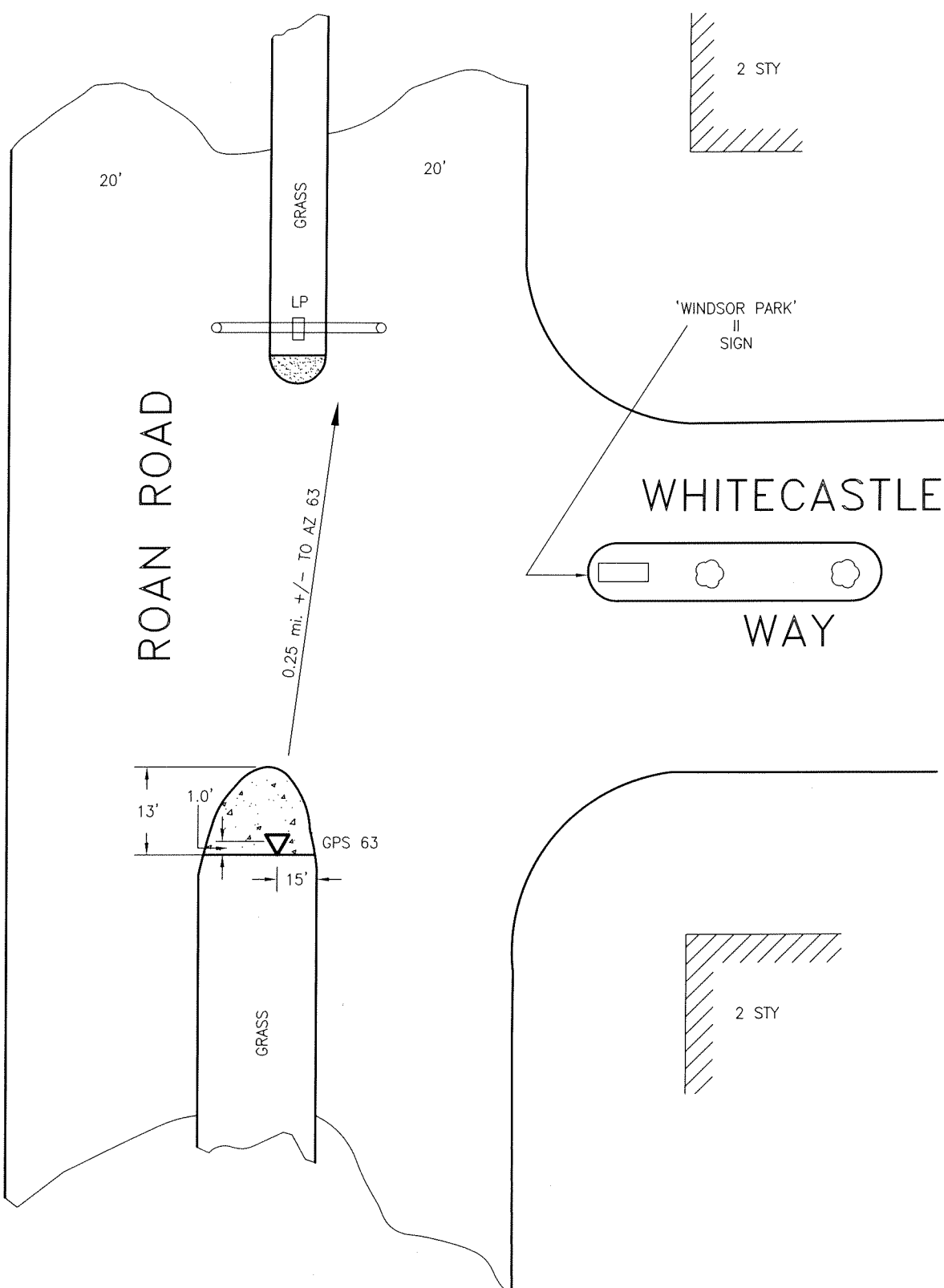
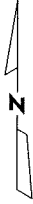

VACANT

Scale : N/A Date : 10/05
 Design : COG
 Drawn : COG
 Dwg. File : GPS63.DWG
 Dir. : G:/ENG/GPS-AZH



Garland Monument
GPS 63
 Dallas Mapsco 40-C

SHEET
 1
 OF
 1



WD PP
WD PP
WD PP

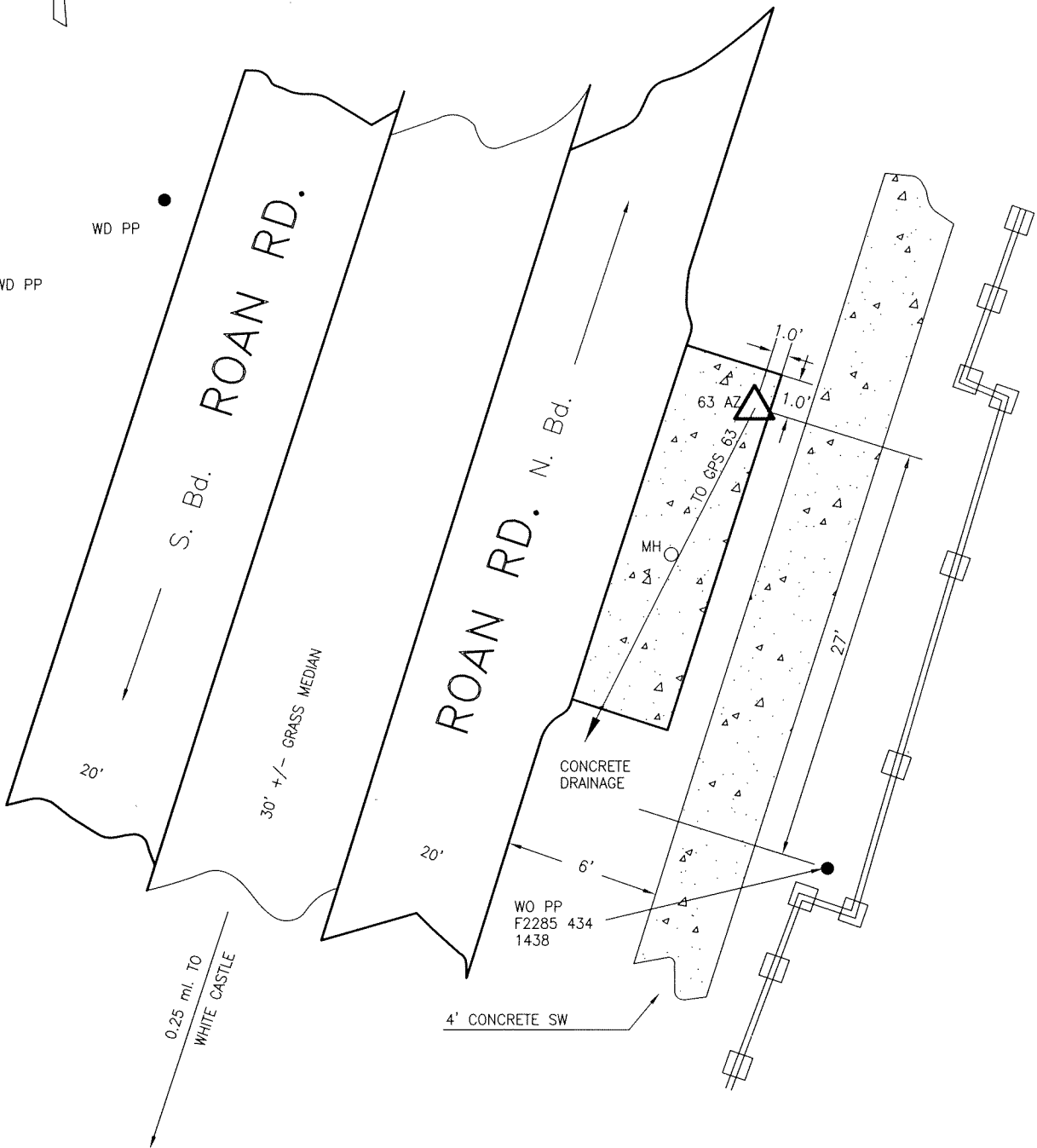

Scale : N/A Date : 10/05
Design : COG
Drawn : COG
Dwg. File : GPS63AZ.DWG
Dir. : G:/ENG/GPS-AZH

GARLAND
ENGINEERING DEPARTMENT
STANDARD DETAILS

Garland Monument
GPS AZIMUTH 63

SHEET
1
OF
1

GPS Station Observation Log

Station Designation (Check applicable: <input checked="" type="checkbox"/> GEO. CNTRL. <input type="checkbox"/> Trav. PT. <input type="checkbox"/> BM)		Station PID, if any: GPS 064	DATE: 5/23/2005
Project Name: Geodetic Monument		Project Number: GPS- 064	
NAD83 Latitude: 32 51 10.84440	NAD83 Longitude: 96 33 43.57790	Stat.4-Char ID: _____	Day of Year: _____
Observation Session Time		NAD83 Ellipsoidal Height 131.640 ft./meters	
Sched. Start: _____ Stop: _____	NAVD88 Orthometric Height 157.336 ft./meters		Session ID: (A,B,C,etc.)
Actual Start: 8:18 AM Stop: 1:00 PM	GEOID03 Geoid Height		Agency Full Name: City of Garland
Epoch Interval = <u>5</u> Seconds	Elevation Mask = _____ Degrees		Operator Full Name: Toney E. Gibson
Receiver Brand & Model: Topcon Hiper Lite-Internal Antenna		Comments: 4HRS STATIC DATA RECORDED.	

Base:	Rover: <u>X</u>	NOTE: ELEV. 516.193 IS ORTHO HT. CALC. BY OPUS.
P/N:01-840802-03	P/N:01-840802-03	
S/N: 263-0243	S/N: 263-0233	
ID:8QATEMNVCHS	ID:8OKPW2V2RR4	

** ANTENNA HEIGHT **	Meters	Feet	NAD83 TXNC (4202)
Slant Height to ARP:	1.7415	5.715	N = 6998760.35284
Vertical Height to ARP:			E = 2563544.43983
			Z = 516.19319
			CSF = 0.99985793
Meters = Feet x (0.3048) Height Entered into receiver = <u>1.708</u> Meters.	Note: &/or sketch ANY unusual conditions. be Very Explicit as to where and how Measured .		

LOG Checked By:	Data File Name(s):	(standard NGS Format = aaaadds.xxx) aaa=4 character ID, ddd=Day of Year,
-----------------	--------------------	---

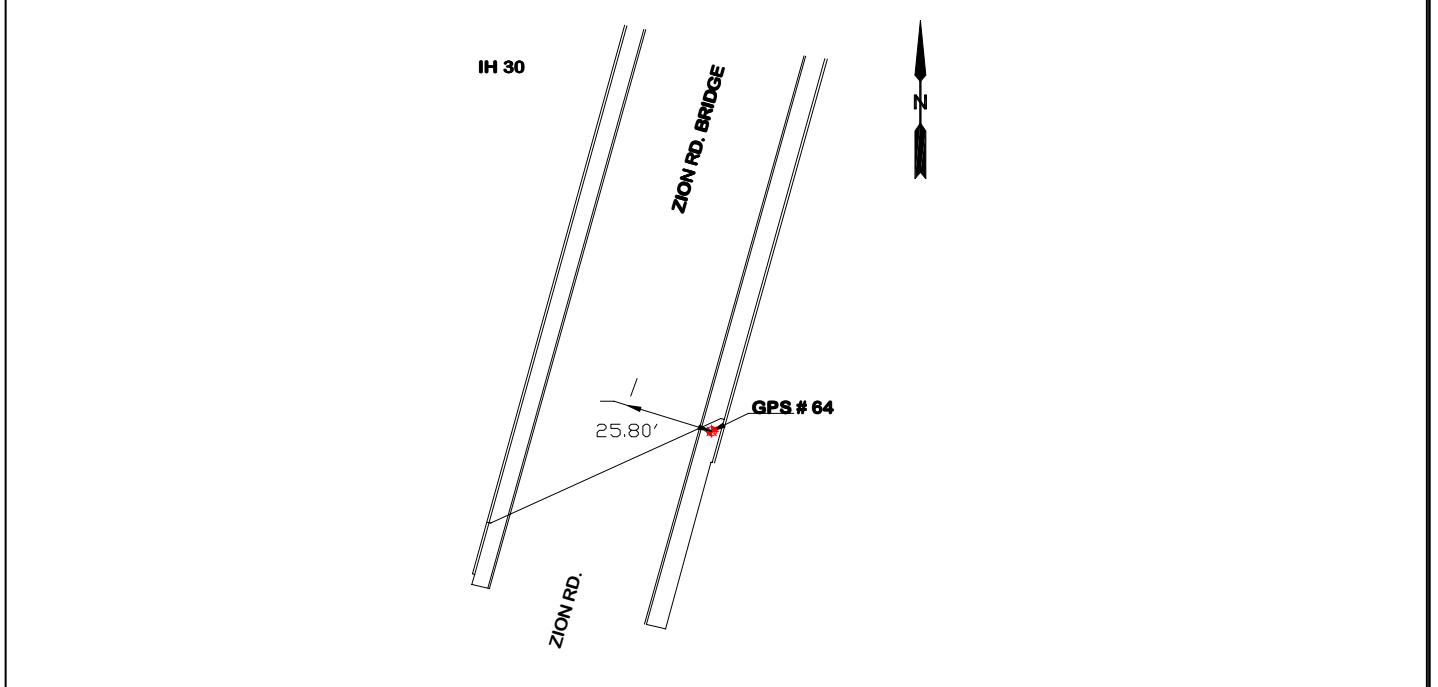

GPS 064, 2" BRASS DISK STAMPED 64 IS LOCATED IN THE S.W. @ THE S.E. END OF THE BRIDGE ON ZION RD. OVER I-30. APPROX. 25.80' E. OF THE C/L OF ZION, AND APPROX. 10' N. OF THE S.E. END OF THE BRIDGE CONCRETE RAIL. ***COG MAP GRID M-13***MAPSCO 40-D***

Table of Weather

Problem	Visibility	Temperature	Cloud Cover	Wind
NONE	GOOD	76°	P/CLOUDY	5 - 10 MPH
Any obstructions above 10° ?		(Y / N)	Radio Interference source nearby ?	
			(Y / N)	

RPLS: GSB P.Chief: TG Field Tech: KW Field Tech: CW

GPS Station Observation Log

Station Designation (Check applicable: <input checked="" type="checkbox"/> GEO. CNTRL. <input type="checkbox"/> Trav. PT. <input type="checkbox"/> BM)		Station PID, if any: GPS 065	DATE: 5/24/2005
Project Name: Geodetic Monument		Project Number: GPS-065	
NAD83 Latitude: 32 51 11.38757		NAD83 Longitude: 96 33 32.83902	
Observation Session Time		122.901 ft./meters	
Sched. Start: _____ Stop: _____		NAVD88 Orthometric Height	
Actual Start: 11:37 AM Stop: 3:40 PM		148.590 ft./meters	
Epoch Interval = 5 Seconds		GEOID03 Geoid Height	
Elevation Mask = _____ Degrees		ft./meters	
Receiver Brand & Model: Topcon Hiper Lite-Internal Antenna		Comments: 4HRS STATIC DATA RECORDED.	
Base: _____		Rover: <u>X</u>	
P/N: 01-840802-03		NOTE: ELEV. 487.499 IS ORTHO HT. CALC. BY OPUS.	
S/N: 263-0243		P/N: 01-840802-03	
ID: 8QATEMNVCHS		S/N: 263-0233	
ID: 8OKPW2V2RR4		ID: 8OKPW2V2RR4	
** ANTENNA HEIGHT **		Meters Feet	
Slant Height to ARP:		1.619 5.31	
Vertical Height to ARP:			
Meters = Feet x (0.3048)		N = 6998832.14404	
Height Entered into receiver = 1.585 Meters.		E = 2564459.27724	
		Z = 487.49903	
		CSF = 0.99985929	
		Note: &/or sketch ANY unusual conditions. be Very Explicit as to where and how Measured .	
LOG Checked By: _____		Data File Name(s): (standard NGS Format = aaaadds.xxx) aaa=4 character ID, ddd=Day of Year,	

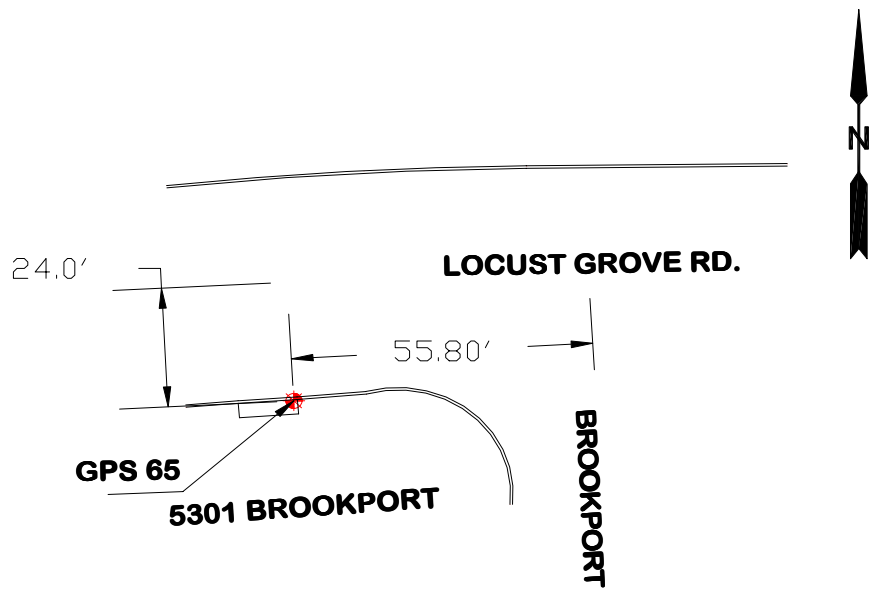

GPS 065, 2" BRASS DISK STAMPED 65 IS LOCATED ON N.W. CORNER OF LOCUST GROVE AND BROOKPORT INT. ON N.W. INLET CORNER ON S. SIDE OF LOCUST GROVE. APPROX. 55.80' W. OF THE C/L OF BROOKPORT AND APPROX. 24' S. OF THE C/L OF LOCUST GROVE. ***COG MAP GRID M-13***MAPSCO 40-D***

Table of Weather

Problem	Visibility	Temperature	Cloud Cover	Wind
NONE	GOOD	85°	CLOUDY	5 - 10 MPH
Any obstructions above 10° ? (Y / N)		Radio Interference source nearby ? (Y / N)		

RPLS: GSB P.Chief: TG Field Tech: KW Field Tech: CW

GPS Station Observation Log

Station Designation (Check applicable: <input checked="" type="checkbox"/> GEO. CNTRL. <input type="checkbox"/> Trav. PT. <input type="checkbox"/> BM)		Station PID, if any: GPS 066	DATE: 6/1/2005
Project Name: Geodetic Monument		Project Number: GPS- 066	
NAD83 Latitude: 32 51 27.31316		NAD83 Longitude: 96 33 08.40615	
Observation Session Time		113.132 ft./meters	
Sched. Start: _____ Stop: _____		NAVD88 Orthometric Height	
Actual Start: 10:35 AM Stop: 3:24 PM		138.802 ft./meters	
Epoch Interval = 5 Seconds		GEOID03 Geoid Height	
Elevation Mask = _____ Degrees		ft./meters	
Receiver Brand & Model: Topcon Hiper Lite-Internal Antenna		Comments: 4HRS STATIC DATA RECORDED.	
Base: <input checked="" type="checkbox"/> X		Rover: _____	
P/N: 01-840802-03		NOTE: ELEV. 455.386 IS ORTHO HT. CALC. BY OPUS.	
S/N: 263-0243		P/N: 01-840802-03	
ID: 8QATEMNVCHS		S/N: 263-0233	
ID: 8OKPW2V2RR4		ID: 8OKPW2V2RR4	
** ANTENNA HEIGHT **		Meters	Feet
Slant Height to ARP:		1.598	5.245
Vertical Height to ARP:			
Meters = Feet x (0.3048)		Note: &/or sketch ANY unusual conditions. be Very Explicit as to where and how Measured .	
Height Entered into receiver = 1.565 Meters.			
LOG Checked By: _____		Data File Name(s): _____ (standard NGS Format = aaaadds.xxx) aaa=4 character ID, ddd=Day of Year,	

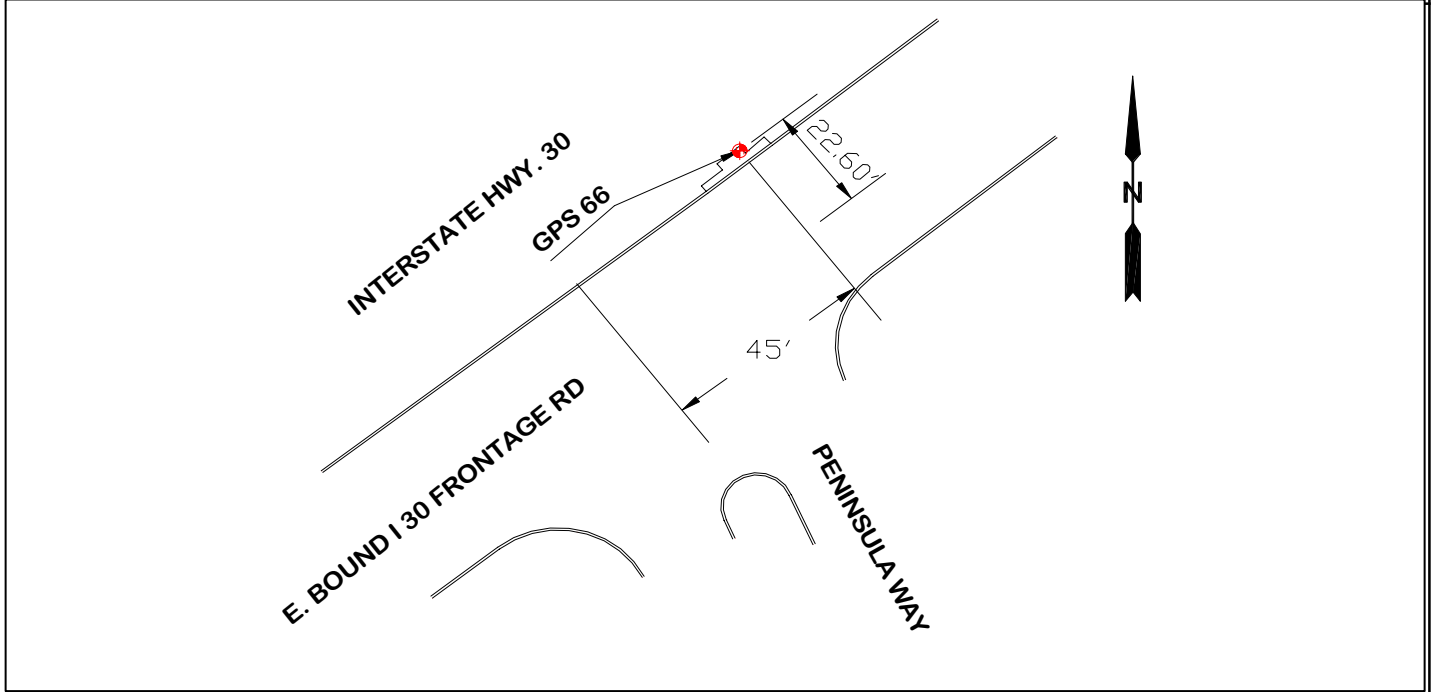

GPS 066, 2" BRASS DISK STAMPED 66 IS LOCATED @ BACK OF INLET ON THE N. SIDE OF E. I-30 SERVICE RD. APPROX. 22' N. OF THE C/L OF E. I-30 SERVICE RD. AND APPROX. 45' N.E. OF THE C/L INT. OF PENINSULA WAY, AND I-30 E. BOUND SERVICE RD. ***COG MAP GRID M-14***MAPSCO 40A-A***

Table of Weather

Problem	Visibility	Temperature	Cloud Cover	Wind
NONE	GOOD	81°	P/CLOUDY	5 - 10 MPH
Any obstructions above 10 °?		(Y / N)	Radio Interference source nearby ? (Y / N)	

RPLS: GSB P.Chief: TG Field Tech: KW Field Tech: CW

GPS Station Observation Log

Station Designation (Check applicable: <input checked="" type="checkbox"/> GEO. CNTRL. <input type="checkbox"/> Trav. PT. <input type="checkbox"/> BM)		Station PID, if any: GPS 067	DATE: 6/1/2005
Project Name: Geodetic Monument		Project Number: GPS-067	
NAD83 Latitude: 32 51 20.53136		NAD83 Longitude: 96 33 05.67410	
Observation Session Time		118.180 m ft./meters	
Sched. Start: _____ Stop: _____		NAVD88 Orthometric Height	
Actual Start: 10:31 AM Stop: 3:27 PM		143.849 m ft./meters	
Epoch Interval = 5 Seconds		GEOID03 Geoid Height	
Elevation Mask = _____ Degrees		ft./meters	

Receiver Brand & Model: Topcon Hiper Lite-Internal Antenna		Comments: 4HRS STATIC DATA RECORDED.	
Base:	Rover: <u>X</u>	NOTE: ELEV. 471.944 IS ORTHO HT. CALC. BY OPUS.	
P/N: 01-840802-03	P/N: 01-840802-03		
S/N: 263-0243	S/N: 263-0233		
ID: 8QATEMNVCHS	ID: 8OKPW2V2RR4		

** ANTENNA HEIGHT **		Meters	Feet	NAD83 TXNC (4202)
Slant Height to ARP:		1.564	5.13	N = 6999798.92032
Vertical Height to ARP:				E = 2566758.86582
Meters = Feet x (0.3048)		Note: &/or sketch ANY unusual conditions. be Very Explicit as to where and how Measured .		
Height Entered into receiver = 1.530 Meters.				

LOG Checked By:	Data File Name(s):	(standard NGS Format = aaaadds.xxx) aaa=4 character ID, ddd=Day of Year,
-----------------	--------------------	---

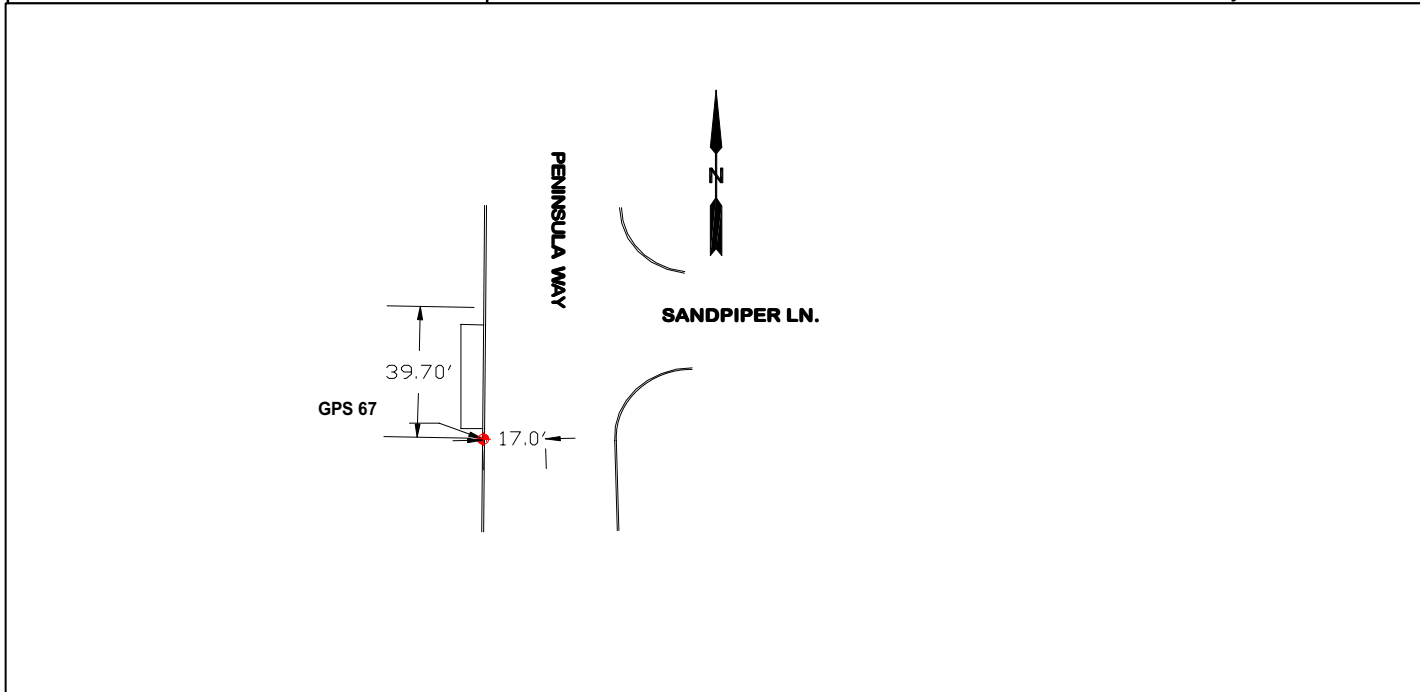

GPS 067, 2" BRASS DISK STAMPED 67 IS LOCATED ON BC APPROX. 17' W. OF THE C/L OF PENINSULA WAY & APPROX. 39.70' S OF INT. OF PENINSULA WAY & SANDPIPER LN.

COG MAP GRID M-14MAPSCO 40A-A***

Table of Weather

Problem	Visibility	Temperature	Cloud Cover	Wind
NONE	GOOD	81°	P/CLOUDY	5 - 10 MPH
Any obstructions above 10° ?		(Y / N)	Radio Interference source nearby ?	
			(Y / N)	

RPLS: GSB P.Chief: TG Field Tech: KW Field Tech: CW

GPS Station Observation Log

Station Designation (Check applicable: <input checked="" type="checkbox"/> GEO. CNTRL. <input type="checkbox"/> Trav. PT. <input type="checkbox"/> BM)		Station PID, if any: GPS 068	DATE: 5/19/2005
Project Name: Geodetic Monument		Project Number: GPS- 068	
NAD83 Latitude: 32 51 10.07079		NAD83 Longitude: 96 32 58.82983	
Observation Session Time		114.516 ft./meters	
Sched. Start: _____ Stop: _____		NAD83 Ellipsoidal Height	
Actual Start: 9:50 AM Stop: 3:30 PM		140.181 ft./meters	
Epoch Interval = 5 Seconds		GEOID03 Geoid Height	
Elevation Mask = _____ Degrees		ft./meters	
Receiver Brand & Model: Topcon Hiper Lite-Internal Antenna		Comments: 4HRS STATIC DATA RECORDED.	
Base: <input checked="" type="checkbox"/>		Rover:	
P/N: 01-840802-03		NOTE: ELEV. 459.910 IS ORTHO HT. CALC. BY OPUS.	
S/N: 263-0243		P/N: 01-840802-03	
ID: 8QATEMNVCHS		S/N: 263-0233	
		ID: 8OKPW2V2RR4	
** ANTENNA HEIGHT **		NAD83 TXNC (4202)	
Slant Height to ARP:		1.520 m	4.985
Vertical Height to ARP:			
Meters = Feet x (0.3048)		N = 6998752.82005	
Height Entered into receiver = 1.4859 Meters.		E = 2567362.17826	
		Z = 459.91050	
		CSF = 0.99986063	
LOG Checked By:		Data File Name(s): (standard NGS Format = aaaadds.xxx) aaa=4 character ID, ddd=Day of Year,	

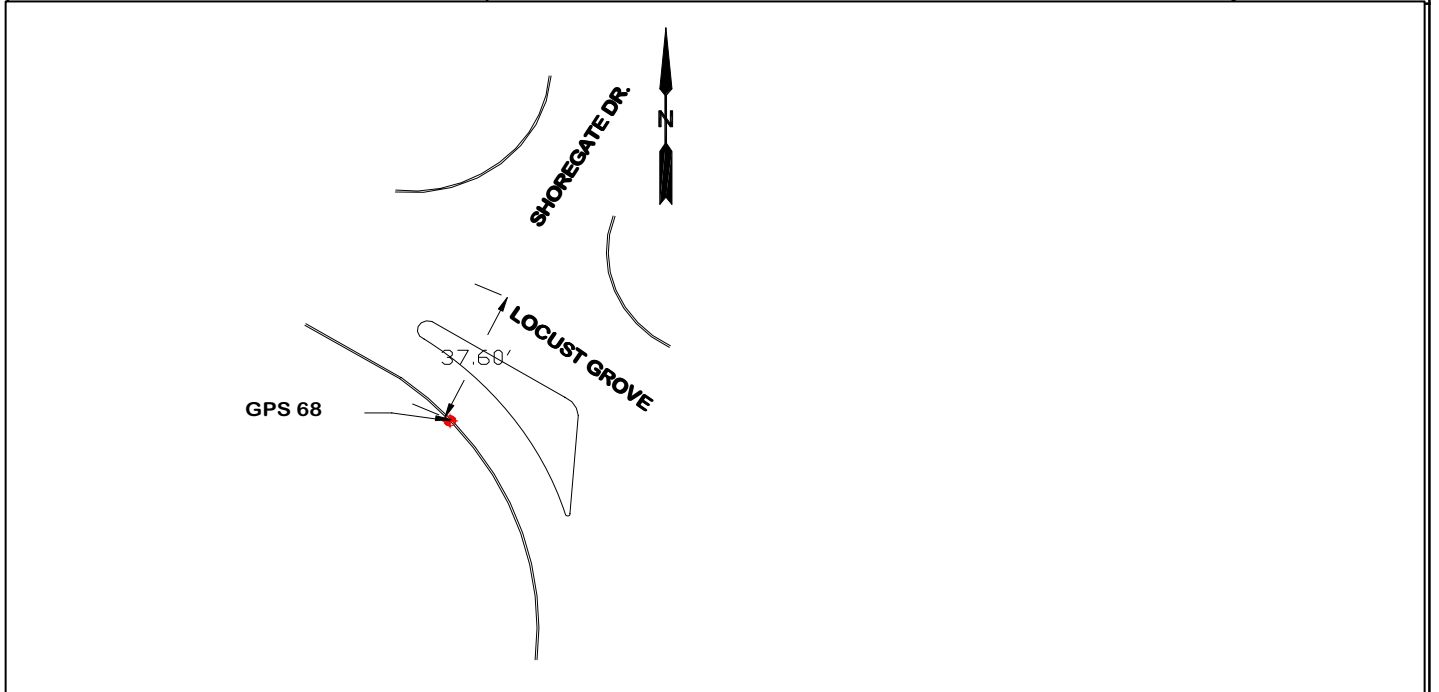

GPS 68, 2" BRASS DISK STAMPED 68, LOCATED ON BC APPROX. 37.60' SW OF LOCUST GROVE & SHOREGATE DR. C.I.L. ON LOCUST GROVE
 COG MAP GRID M-14 ***MAPSCO 40A-B

Table of Weather

Problem	Visibility	Temperature	Cloud Cover	Wind
NONE	GOOD	75°	CLOUDY	15 - 20 MPH
Any obstructions above 10° ?		(Y / N)	Radio Interference source nearby ?	(Y / N)

RPLS: GSB P.Chief: TG Field Tech: KW Field Tech: CW

GPS Station Observation Log

Station Designation (Check applicable: <input checked="" type="checkbox"/> GEO. CNTRL. <input type="checkbox"/> Trav. PT. <input type="checkbox"/> BM)		Station PID, if any: GPS 069	DATE: 5/25/2005
Project Name: Geodetic Monument		Project Number: GPS- 069	
NAD83 Latitude: 32 51 11.78690	NAD83 Longitude: 96 33 05.83642	Stat.4-Char ID: _____	Day of Year: _____
Observation Session Time		Session ID: (A,B,C,etc.)	
Sched. Start: _____ Stop: _____		Agency Full Name: City of Garland	
Actual Start: 8:56 AM Stop: 2:30 PM		Operator Full Name: Toney E. Gibson	
Epoch Interval = <u>5</u> Seconds		Phone# (972) 205 - 2157	
Elevation Mask = _____ Degrees		E-mail: gbreysac@ci.garland.tx.us	

Receiver Brand & Model: Topcon Hiper Lite-Internal Antenna **Comments:** 5HRS 30 MIN. STATIC DATA RECORDED.

Base:	Rover: <u>X</u>	NOTE: ELEV. 477.161 IS ORTHO HT. CALC. BY OPUS.
P/N:01-840802-03	P/N:01-840802-03	
S/N: 263-0243	S/N: 263-0233	
ID:8QATEMNVCHS	ID:8OKPW2V2RR4	

** ANTENNA HEIGHT **	Meters	Feet	NAD83 TXNC (4202)
Slant Height to ARP:	1.684	5.525	N = 6998915.12616 E = 2566761.41174
Vertical Height to ARP:			Z = 477.16112 CSF = 0.99985978
Meters = Feet x (0.3048) Height Entered into receiver = <u>1.6505</u> Meters.	Note: &/or sketch ANY unusual conditions. be Very Explicit as to where and how Measured .		

LOG Checked By:	Data File Name(s): (standard NGS Format = aaaadds.xxx) aaa=4 character ID, ddd=Day of Year,
-----------------	--

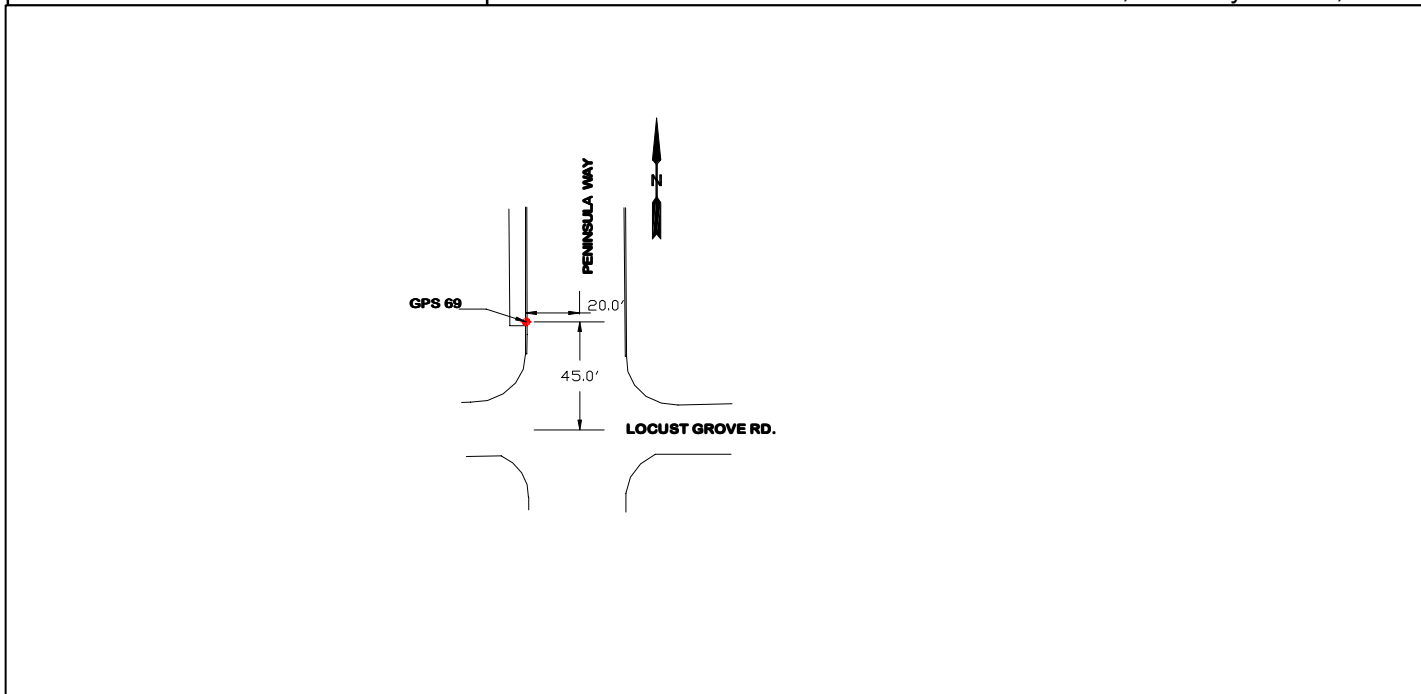

GPS 069, 2" BRASS DISK STAMPED 69 IS LOCATED ON THE BC APPROX. 45' N. OF THE INT. OF LOCUST GROVE & PENINSULA WAY. APPROX. 20' W. OF C/L OF PENINSULA WAY.

COG MAP GRID M-13MAPSCO 40A-A***

Table of Weather

Problem	Visibility	Temperature	Cloud Cover	Wind
NONE	GOOD	80°	P/CLOUDY	5 - 10 MPH
Any obstructions above 10° ?		(Y / N)	Radio Interference source nearby ? (Y / N)	

RPLS: GSB P.Chief: TG Field Tech: KW Field Tech: CW

GPS Station Observation Log

Station Designation (Check applicable: <input checked="" type="checkbox"/> GEO. CNTRL. <input type="checkbox"/> Trav. PT. <input type="checkbox"/> BM)		Station PID, if any: GPS 070	DATE: 5/20/2005
Project Name: Geodetic Monument		Project Number: GPS-070	
NAD83 Latitude: 32 50 58.43489		NAD83 Longitude: 96 32 52.24514	
Observation Session Time		116.454 ft./meters	
Sched. Start: _____ Stop: _____		NAVD88 Orthometric Height	
Actual Start: 9:05 AM Stop: 2:00 PM		142.116 ft./meters	
Epoch Interval = 5 Seconds		GEOID03 Geoid Height	
Elevation Mask = _____ Degrees		ft./meters	
Receiver Brand & Model: Topcon Hiper Lite-Internal Antenna		Comments: 4HRS 55 MIN. STATIC DATA RECORDED.	
Base: _____		Rover: <u>X</u>	
P/N: 01-840802-03		NOTE: ELEV. 466.258 IS ORTHO HT. CALC. BY OPUS.	
S/N: 263-0243		P/N: 01-840802-03	
ID: 8QATEMNVCHS		S/N: 263-0233	
		ID: 8OKPW2V2RR4	

** ANTENNA HEIGHT **		Meters	Feet	NAD83 TXNC (4202)
Slant Height to ARP:	1.679	5.505	N = 6997587.55991	
Vertical Height to ARP:			E = 2567945.59573	
			Z = 466.25891	
			CSF = 0.99986052	
Meters = Feet x (0.3048) Height Entered into receiver = 1.6444 Meters.		Note: &/or sketch ANY unusual conditions. be Very Explicit as to where and how Measured.		

LOG Checked By: _____	Data File Name(s): _____ (standard NGS Format = aaaadds.xxx) aaa=4 character ID, ddd=Day of Year,
-----------------------	---

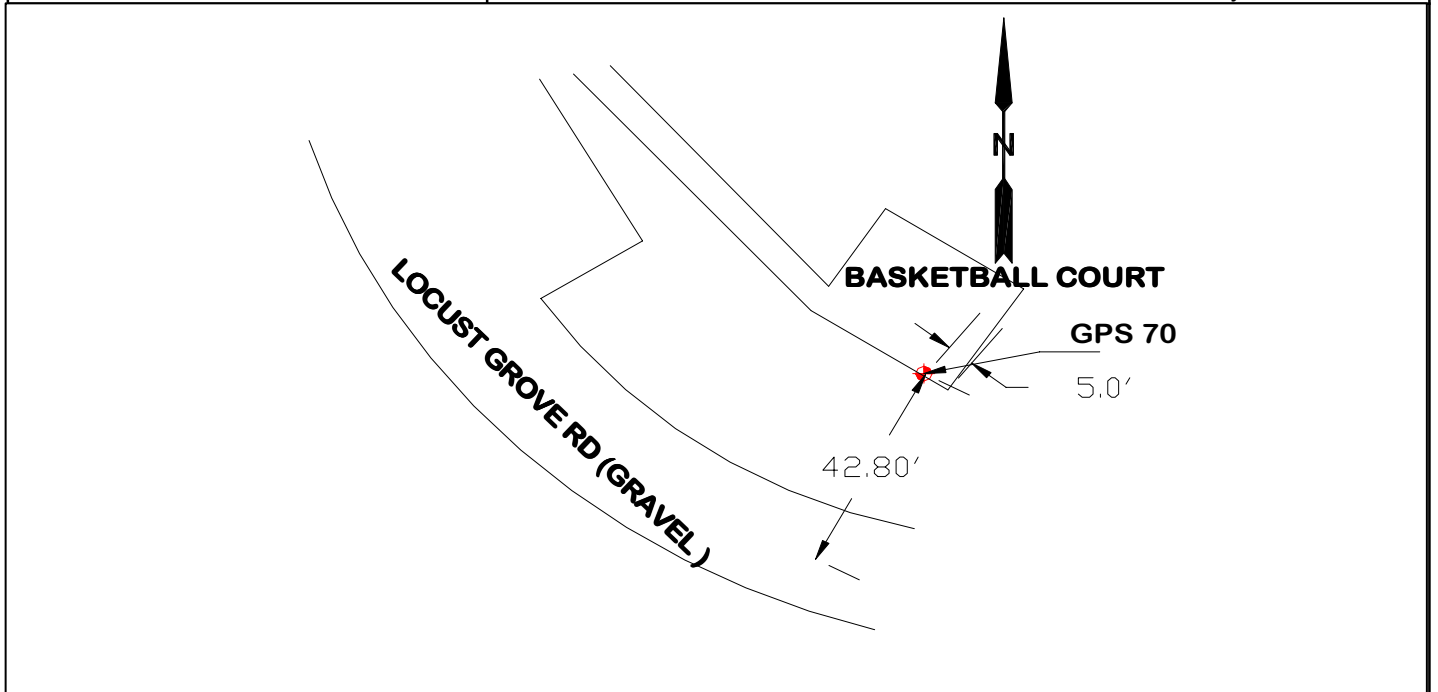

GPS 70, 2" BRASS DISK STAMPED 70 IS LOCATED IN WINDSURF BAY PARK @ THE S.E. COR. OF THE BASKETBALL COURT. APPROX. 5' NW. OF THE E. EDGE AND APPROX. 42.80' NE. OF LOCUST GROVE (GRAVEL RD C/L. ***COG MAP GRID M-14***MAPSCO 40A-B***

Table of Weather

Problem	Visibility	Temperature	Cloud Cover	Wind
NONE	GOOD	74°	CLEAR	5 - 10 MPH
Any obstructions above 10° ?		(Y / N)	Radio Interference source nearby ?	
			(Y / N)	

RPLS: GSB P.Chief: TG Field Tech: KW Field Tech: CW

GPS Station Observation Log

Station Designation (Check applicable: <input checked="" type="checkbox"/> GEO. CNTRL. <input type="checkbox"/> Trav. PT. <input type="checkbox"/> BM)		Station PID, if any: GPS 071	DATE: 6/23/2005
Project Name: Geodetic Monument		Project Number: GPS-071	
NAD83 Latitude: 32 51 33.02874		NAD83 Longitude: 96 33 00.89809	
Observation Session Time		110.111 ft./meters	
Sched. Start: _____ Stop: _____		NAVD88 Orthometric Height	
Actual Start: 8:30 AM Stop: 2:07 PM		135.776 ft./meters	
Epoch Interval = 5 Seconds		GEOID03 Geoid Height	
Elevation Mask = _____ Degrees		ft./meters	
Receiver Brand & Model: Topcon Hiper Lite-Internal Antenna		Comments: 5HRS 37MIN. STATIC DATA RECORDED.	
Base:		Rover: <u>X</u>	
P/N: 01-840802-03		NOTE: ELEV. IS ORTHO HT. CALC. BY OPUS.	
S/N: 263-0243		P/N: 01-840802-03	
ID: 8QATEMNVCHS		S/N: 263-0233	
ID: 8OKPW2V2RR4			
** ANTENNA HEIGHT **		NAD83 TXNC (4202)	
Slant Height to ARP:		Meters	Feet
		1.698	5.57
Vertical Height to ARP:			
Meters = Feet x (0.3048)		Note: &/or sketch ANY unusual conditions. be Very Explicit as to	
Height Entered into receiver = 1.643 Meters.		where and how Measured .	
LOG Checked By:		Data File Name(s): (standard NGS Format = aaaadds.xxx) aaa=4 character ID, ddd=Day of Year,	

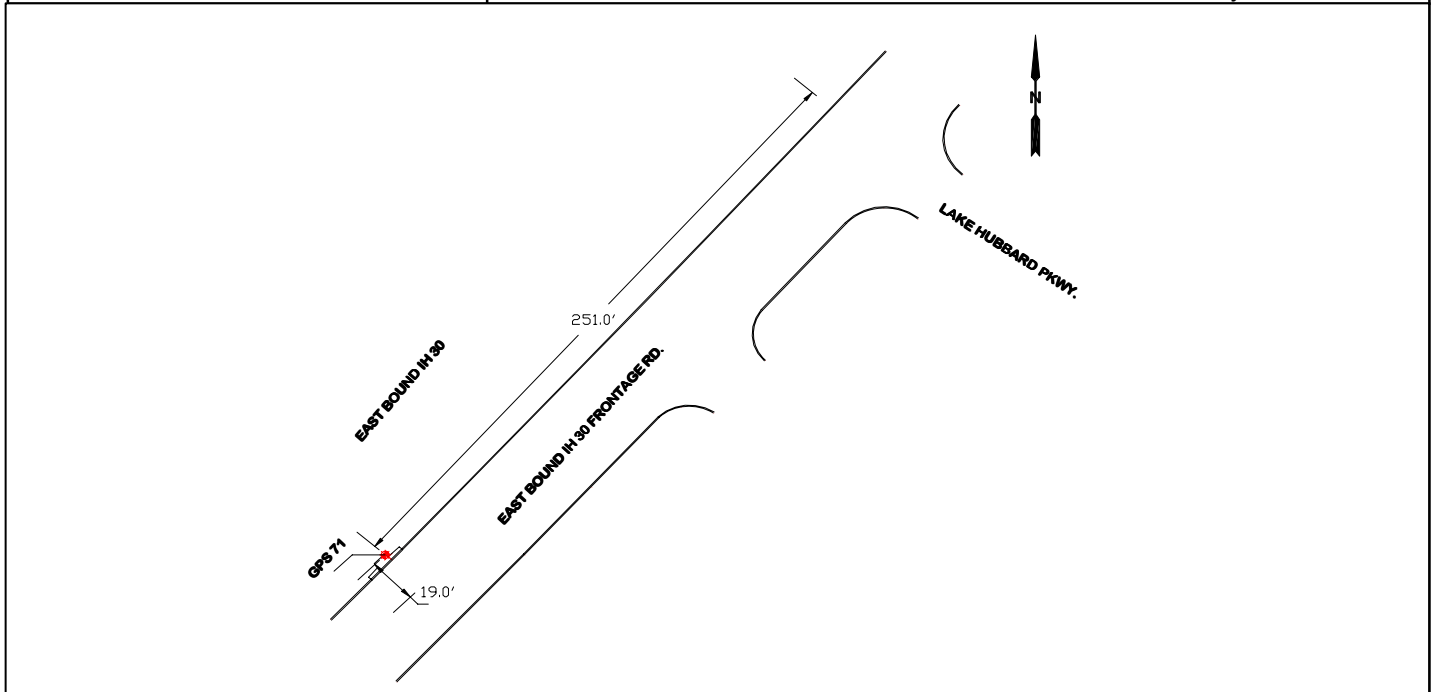

GPS 71, 2" BRASS DISK STAMPED 71 IS LOCATED ON TOP OF INLET APPROX. 22' N. OF C/L OF I-30 SERVICE RD. AND APPROX. 110' W. OF CHAHA RD. EXIT SIGN.
 COG MAP GRID L-14MAPSCO 30A-W***

Table of Weather

Problem	Visibility	Temperature	Cloud Cover	Wind
NONE	GOOD	75°	CLEAR	5 - 10 MPH
Any obstructions above 10° ?		(Y / N)	Radio Interference source nearby ? (Y / N)	

RPLS: GSB P.Chief: TG Field Tech: KW Field Tech: CW

GPS Station Observation Log

Station Designation (Check applicable: <input checked="" type="checkbox"/> GEO. CNTRL. <input type="checkbox"/> Trav. PT. <input type="checkbox"/> BM)		Station PID, if any: GPS 072	DATE: 6/25/2005
Project Name: Geodetic Monument		Project Number: GPS-072	
NAD83 Latitude: 32 51 41.38719		NAD83 Longitude: 96 32 51.15284	
Observation Session Time		118.627 ft./meters	
Sched. Start: _____ Stop: _____		NAVD88 Orthometric Height	
Actual Start: 8:35 AM Stop: 2:00 PM		144.284 ft./meters	
Epoch Interval = 5 Seconds		GEOID03 Geoid Height	
Elevation Mask = _____ Degrees		ft./meters	
Receiver Brand & Model: Topcon Hiper Lite-Internal Antenna		Comments: 5HRS 25MIN. STATIC DATA RECORDED.	
Base: <input checked="" type="checkbox"/>		Rover:	
P/N: 01-840802-03		P/N: 01-840802-03	
S/N: 263-0243		S/N: 263-0233	
ID: 8QATEMNVCHS		ID: 8OKPW2V2RR4	
** ANTENNA HEIGHT **		Meters	Feet
Slant Height to ARP:		1.542	5.055
Vertical Height to ARP:			
Meters = Feet x (0.3048)		Note: &/or sketch ANY unusual conditions. be Very Explicit as to where and how Measured .	
Height Entered into receiver = 1.507 Meters.			
LOG Checked By:	Data File Name(s):	(standard NGS Format = aaaadds.xxx) aaa=4 character ID, ddd=Day of Year,	

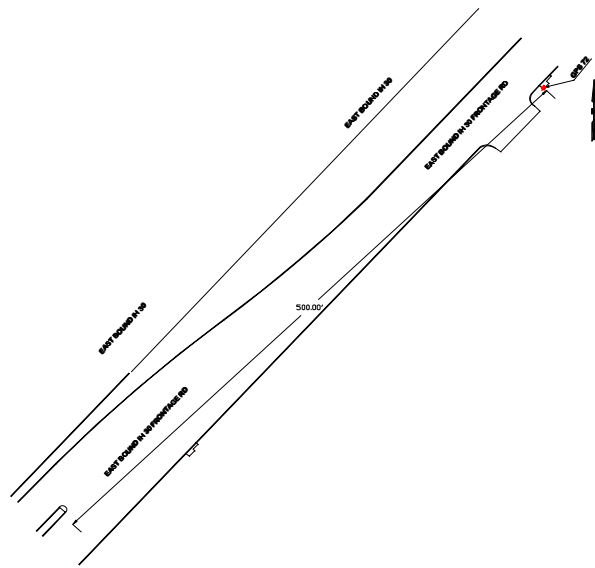

GPS 72, 2" BRASS DISK STAMPED 72, LOCATED APPROX. 500' N.E. OF IH-30 SERVICE RD. AT BASS PRO & CHAHA #62 EXIT RAMP. ON INLET TOP S. SIDE OF IH-30 E. BOUND FRONTAGE RD.
 COG MAP GRID L-14MAPSCO 30A-X***

Table of Weather

Problem	Visibility	Temperature	Cloud Cover	Wind
NONE	GOOD	75°	CLEAR	5 - 10 MPH
Any obstructions above 10° ?		(Y / N)	Radio Interference source nearby ? (Y / N)	
RPLS: <u>GSB</u>	P.Chief: <u>TG</u>	Field Tech: <u>KW</u>	Field Tech: <u>CW</u>	

GPS Station Observation Log

Station Designation (Check applicable: <input checked="" type="checkbox"/> GEO. CNTRL. <input type="checkbox"/> Trav. PT. <input type="checkbox"/> BM)		Station PID, if any: GPS 073	DATE: 8/30/2005
Project Name: Geodetic Monument		Project Number: GPS-073	
NAD83 Latitude: 32 52 04.21237		NAD83 Longitude: 96 39 22.40373	
Observation Session Time		147.748 ft./meters	
Sched. Start: _____ Stop: _____		NAVD88 Orthometric Height	
Actual Start: 10:28 AM Stop: 2:31 PM		173.708 ft./meters	
Epoch Interval = 5 Seconds		GEOID03 Geoid Height	
Elevation Mask = _____ Degrees		ft./meters	

Receiver Brand & Model: Topcon Hiper Lite-Internal Antenna		Comments: 4HRS. STATIC DATA RECORDED.	
Base:	Rover: <u>X</u>	NOTE: ELEV. 569.91 IS ORTHO HT. CALC. BY OPUS.	
P/N: 01-840802-03	P/N: 01-840802-03		
S/N: 263-0243	S/N: 263-0233		
ID: 8QATEMNVCHS	ID: 8OKPW2V2RR4		

** ANTENNA HEIGHT **	Meters	Feet	NAD83 TXNC (4202)
Slant Height to ARP:		5.45	N = 7003632.59048 E = 2534553.14283
Vertical Height to ARP:			Z = 569.90700 CSF = 0.99985454
Meters = Feet x (0.3048) Height Entered into receiver = 1.6276 Meters.	Note: &/or sketch ANY unusual conditions. be Very Explicit as to where and how Measured .		

LOG Checked By:	Data File Name(s):	(standard NGS Format = aaaadds.xxx) aaa=4 character ID, ddd=Day of Year,
-----------------	--------------------	---

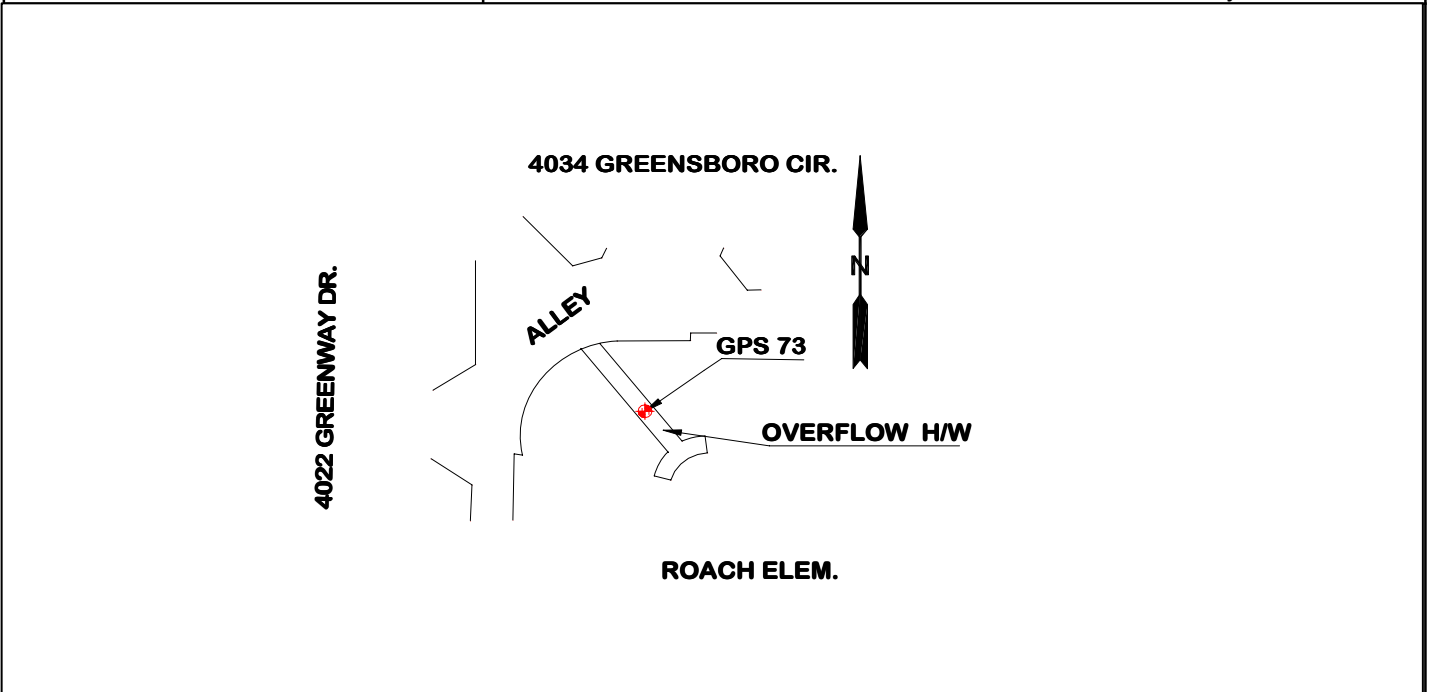

GPS 73, 2" BRASS DISK STAMPED 73 IS LOCATED IN THE TOP OF CONCRETE OVERFLOW H/W @ THE N.W. END OF PLAYGROUND @ ROACH ELEM. SCHOOL ACROSS THE ALLEY @ THE REAR OF 4034 GREENSBORO
 COG MAP GRID L-6MAPSCO 29-T***

Table of Weather				
Problem	Visibility	Temperature	Cloud Cover	Wind
NONE	GOOD	83°	CLEAR	5 - 10 MPH
Any obstructions above 10° ?		(Y / N)	Radio Interference source nearby ?	
			(Y / N)	
RPLS: <u>GSB</u>	P.Chief: <u>TG</u>	Field Tech: <u>KW</u>	Field Tech: <u>CW</u>	

GPS Station Observation Log

Station Designation (Check applicable: <input checked="" type="checkbox"/> GEO. CNTRL. <input type="checkbox"/> Trav. PT. <input type="checkbox"/> BM)		Station PID, if any: GPS 074	DATE: 9/27/2005
Project Name: Geodetic Monument		Project Number: GPS-074	
NAD83 Latitude: 32 58 28.26819		NAD83 Longitude: 96 37 25.13311	
Observation Session Time		123.912 ft./meters	
Sched. Start: _____ Stop: _____		NAVD88 Orthometric Height	
Actual Start: 8:00 AM Stop: 12:03 PM		149.72 ft./meters	
Epoch Interval = _____ Seconds		GEOID03 Geoid Height	
Elevation Mask = _____ Degrees		ft./meters	
Receiver Brand & Model: Topcon Hiper Lite-Internal Antenna		Comments: 4HRS STATIC DATA RECORDED.	

Base:	Rover: <input checked="" type="checkbox"/>	NOTE: ELEV. IS ORTHO HT. CALC. BY OPUS.
P/N:01-840802-03	P/N:01-840802-03	
S/N: 263-0243	S/N: 263-0233	
ID:8QATEMNVCHS	ID:8OKPW2V2RR4	

** ANTENNA HEIGHT **	Meters	Feet	NAD83 TXNC (4202)
Slant Height to ARP:	1.725	5.66	N = 7042615.41605 E = 2543859.73182
Vertical Height to ARP:			Z = 491.20637 CSF = 0.99985407
Meters = Feet x (0.3048) Height Entered into receiver = 1.6916 Meters.	Note: &/or sketch ANY unusual conditions. be Very Explicit as to where and how Measured .		

LOG Checked By:	Data File Name(s):	(standard NGS Format = aaaadds.xxx) aaa=4 character ID, ddd=Day of Year,
-----------------	--------------------	---

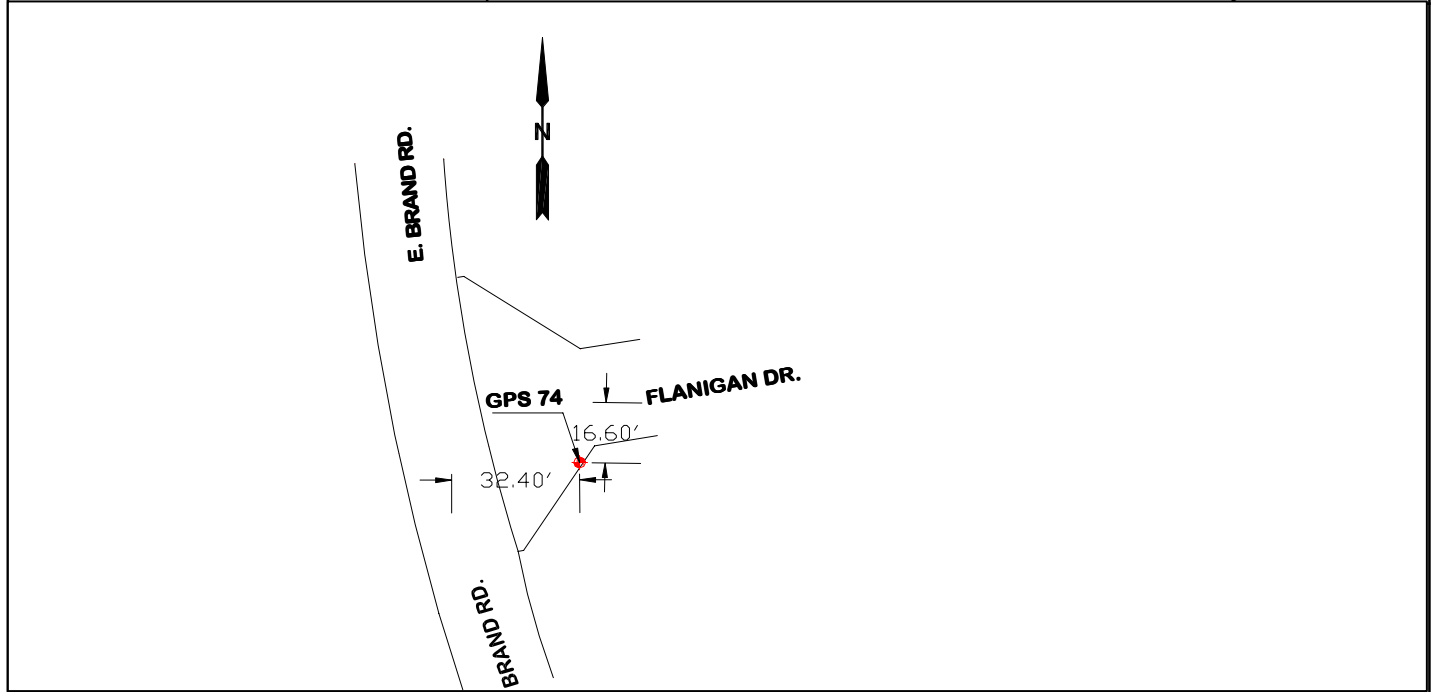

GPS 074, 2" BRASS DISK STAMPED 74, LOCATED SET IN CONCRETE PAVING @ THE INT. OF FLANIGAN AND BRAND RD. APPROX. 32' E. OF THE C/L OF BRAND RD. AND APPROX. 16' S. OF FLANIGAN DR. C/L.
 COG MAP GRID B-8MAPSCO 9A-S***

Table of Weather

Problem	Visibility	Temperature	Cloud Cover	Wind
NONE	GOOD	77°	P/CLOUDY	5 - 10 MPH
Any obstructions above 10° ?		(Y / N)	Radio Interference source nearby ?	(Y / N)

RPLS: GSB P.Chief: TG Field Tech: KW Field Tech: CW

GPS Station Observation Log

Station Designation (Check applicable: <input checked="" type="checkbox"/> GEO. CNTRL. <input type="checkbox"/> Trav. PT. <input type="checkbox"/> BM)		Station PID, if any: GPS 075	DATE: 9/27/2005
Project Name: Geodetic Monument		Project Number: GPS-075	
NAD83 Latitude: 32 58 40.28978		NAD83 Longitude: 96 37 22.93785	
Observation Session Time		133.459 ft./meters	
Sched. Start: _____ Stop: _____		NAVD88 Orthometric Height	
Actual Start: 7:54 AM Stop: 12:00 PM		159.263 ft./meters	
Epoch Interval = <u>10</u> Seconds		GEOID03 Geoid Height	
Elevation Mask = _____ Degrees		ft./meters	

Receiver Brand & Model: Topcon Hiper Lite-Internal Antenna		Comments: 4HRS STATIC DATA RECORDED.	
Base: <u>X</u>	Rover:	NOTE: ELEV. 522.52 IS ORTHO HT. CALC. BY OPUS.	
P/N: 01-840802-03	P/N: 01-840802-03		
S/N: 263-0243	S/N: 263-0233		
ID: 8QATEMNVCHS	ID: 8OKPW2V2RR4		

** ANTENNA HEIGHT **	Meters	Feet	NAD83 TXNC (4202)
Slant Height to ARP:	1.672	5.485	N = 7043833.44839
Vertical Height to ARP:			E = 2544024.99068
			Z = 522.52
			CSF = 0.99985250
Meters = Feet x (0.3048) Height Entered into receiver = <u>1.6383</u> Meters.	Note: &/or sketch ANY unusual conditions. be Very Explicit as to where and how Measured .		

LOG Checked By:	Data File Name(s):	(standard NGS Format = aaaadds.xxx) aaa=4 character ID, ddd=Day of Year,
-----------------	--------------------	---

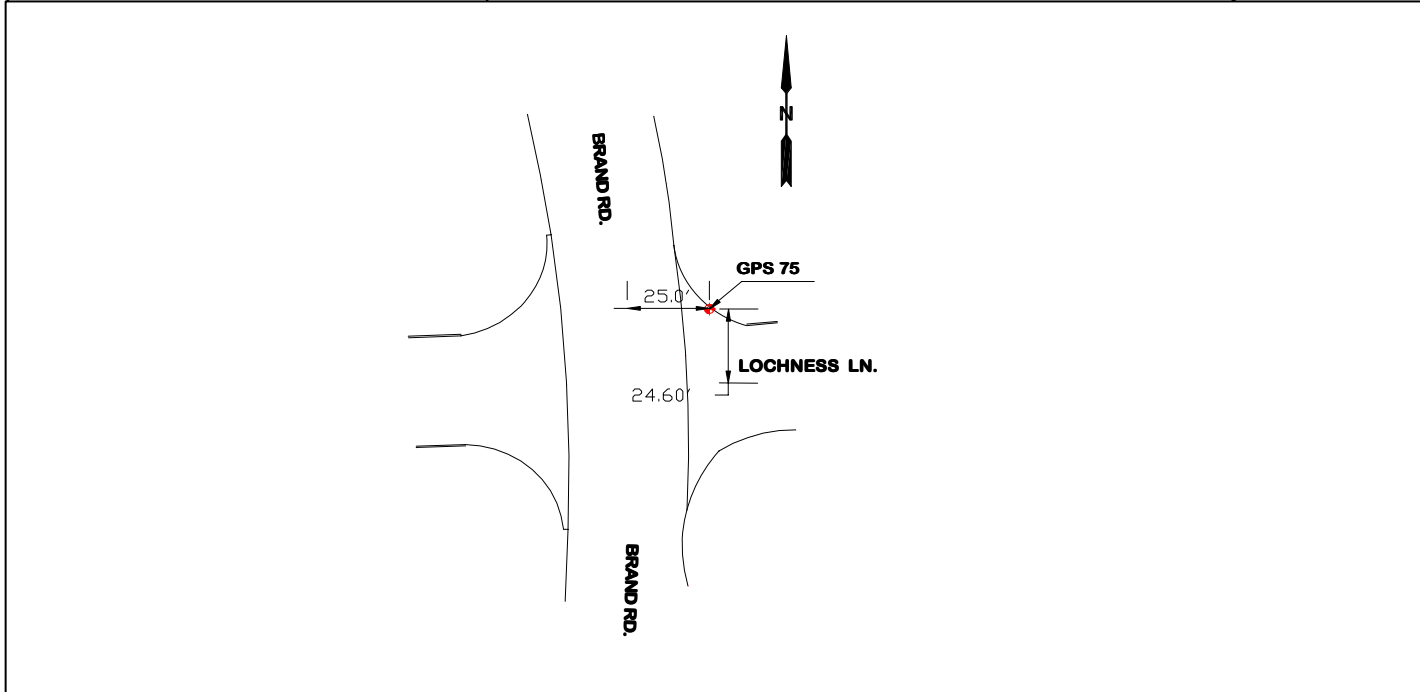

GPS 75, 2" BRASS DISK STAMPED 75, LOCATED IN THE CONCRETE PAVING AT THE INT. OF BRAND RD. AND LOCHNESS LN. APPROX. 25' E. OF BRAND RD. C/L. & APPROX. 25' N. OF LOCHNESS LN. C/L.

COG MAP GRID B-8MAPSCO 9A-S***

Table of Weather

Problem	Visibility	Temperature	Cloud Cover	Wind
NONE	GOOD	80°	P/ CLOUDY	5 - 10 MPH
Any obstructions above 10° ?		(Y / N)	Radio Interference source nearby ?	(Y / N)

RPLS: GSB P.Chief: TG Field Tech: KW Field Tech: CW